

Product: Flexi-Coil 40 and 50 Series(1740,2340,2640,3450,3850,4350) Air Cart Service Repair Manual
Full Download: <https://www.aresairmanual.com/downloads/flexi-coil-40-and-50-series174023402640345038504350-air-cart-service-repair-manual/>

40 Series 50 Series Air Cart

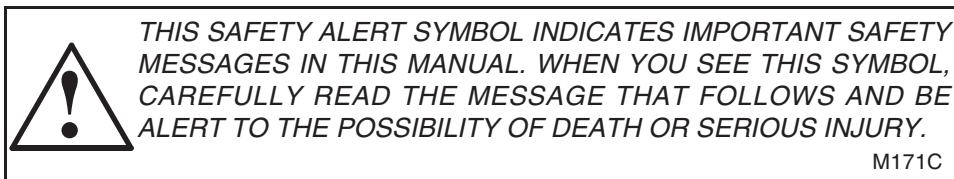

Service Manual



If Safety Decals on this machine use the words **Danger, Warning or Caution**, which are defined as follows:

- **DANGER:** Indicates an immediate hazardous situation that, if not avoided, will result in death or serious injury. The color associated with Danger is RED.
- **WARNING:** Indicates a potentially hazardous situation that, if not avoided, could result in death or serious injury. The color associated with Warning is ORANGE.
- **CAUTION:** Indicates an potentially hazardous situation that, if not avoided, may result in minor or moderate injury. It may also be used to alert against unsafe practices. The color associated with Caution is YELLOW.

If Safety Decals on this machine are ISO two panel Pictorial, decals are defined as follows:

- The first panel indicates the nature of the hazard.
- The second panel indicates the appropriate avoidance of the hazard.
- Background color is YELLOW.
- Prohibition symbols such as   and  if used, are RED.



WARNING

IMPROPER OPERATION OF THIS MACHINE CAN CAUSE DEATH OR SERIOUS INJURY. BEFORE USING THIS MACHINE, MAKE CERTAIN THAT EVERY OPERATOR:

- Is instructed in safe and proper use of the machine.
- Reads and understands the Manual(s) pertaining to the machine.
- Reads and understands ALL Safety Decals on the machine.
- Clears the area of other persons.
- Learns and practices safe use of machine controls in a safe, clear area before operating this machine on a job site.

It is your responsibility to observe pertinent laws and regulations and follow CNH America LLC instructions on machine operation and maintenance.

GI-090V1

Issued January, 2005

Contents

INTRODUCTION	
DISTRIBUTION SYSTEMS	A
TRAVELLING	D
WORKING ARM	H
FIELD PROCESSING	L



INTRODUCTION

Contents

INTRODUCTION

Foreword (- A.10.A.40)	3
1740, 2340, 2640, 3450, 3850, 4350	
Decals (- A.50.A.30)	12
1740, 2340	
Decals (- A.50.A.30)	20
2640	
Decals (- A.50.A.30)	27
3450, 3850, 4350	
Hand signals (- A.50.A.20)	34
1740, 2340, 2640, 3450, 3850, 4350	
Safety rules (- A.50.A.10)	37
1740, 2340, 2640, 3450, 3850, 4350	
Torque (- A.90.A.10)	43
1740, 2340, 2640, 3450, 3850, 4350	
Basic instructions (- A.90.A.05)	45
1740, 2340, 2640, 3450, 3850, 4350	
Definition (- A.92.A.15)	47
1740, 2340, 2640, 3450, 3850, 4350	
Abbreviation (- A.92.A.20)	49
1740, 2340, 2640, 3450, 3850, 4350	
Power specification (- A.92.A.11)	51
1740, 2340, 2640, 3450, 3850, 4350	
General specification (- A.92.A.10)	53
1740, 2340, 2640	
General specification (- A.92.A.10)	60
3450, 3850, 4350	
Product identification (- A.80.A.10)	62
1740, 2340, 2640, 3450, 3850, 4350	
Product identification (- A.80.A.10)	63
1740, 2340	
Product identification (- A.80.A.10)	68
2640	
Product identification (- A.80.A.10)	70
3450, 3850, 4350	
Product identification (- A.80.A.10)	72
1740, 2340, 2640, 3450, 3850, 4350	
Product identification (- A.80.A.10)	73
1740, 2340	
Product identification (- A.80.A.10)	74
2640	
Product identification (- A.80.A.10)	75
3450, 3850, 4350	

Foreword (- A.10.A.40)

1740, 2340, 2640, 3450, 3850, 4350

ASIST linked to Technical Information

This manual has been produced by a new technical information system which is part of ASIST. This new system is designed to deliver technical information electronically through ASIST, also on CDROM and in paper manuals. A coding system called ICE has been developed to link the technical information to ASIST and to other Product Support functions e.g. Warranty.

Technical information is written to support the maintenance and service of the functions or systems on a customers machine. When a customer has a concern on his machine it is usually because a function or system on his machine is not working at all, is not working efficiently, or is not responding correctly to his commands. When you refer to the technical information in this manual to resolve that customers concern, you will find all the information classified using the new ICE coding, according to the functions or systems on that machine. Once you have located the technical information for that function or system then you will find all the mechanical, electrical or hydraulic devices, components, assemblies and sub-assemblies for that function or system. You will also find all the types of information that have been written for that function or system, the technical data (specifications), the functional data (how it works), the diagnostic data (fault codes and troubleshooting) and the service data (remove, install adjust, etc.).

By integrating this new ICE coding into technical information and ASIST, you will be able to search and retrieve just the right piece of technical information you need to resolve that customers concern on his machine. This is made possible by attaching 3 categories to each piece of technical information during the authoring process.

The first category is the Location, the second category is the Information Type and the third category is the Product:

- **LOCATION** - is the component or function on the machine, that the piece of technical information is going to describe e.g. Fuel tank.
- **INFORMATION TYPE** - is the piece of technical information that has been written for a particular component or function on the machine e.g. Capacity would be a type of Technical Data that would describe the amount of fuel held by the Fuel tank.
- **PRODUCT** - is the model that the piece of technical information is written for.

Every piece of technical information will have those 3 categories attached to it. You will be able to use any combination of those categories to find the right piece of technical information you need to resolve that customers concern on his machine.

That information could be:

- the description of how to remove the cylinder head
- a table of specifications for a hydraulic pump
- a fault code
- a troubleshooting table
- a special tool

How to Use this Manual

This manual is divided into Sections. Each Section is then divided into Chapters. Contents pages are included at the beginning of the manual, then inside every Section and inside every Chapter. An alphabetical Index is included at the end of a Chapter. Page number references are included for every piece of technical information listed in the Chapter Contents or Chapter Index.

Each Chapter is divided into four Information types:

- **Technical Data** (specifications) for all the mechanical, electrical or hydraulic devices, components and assemblies.
- **Functional Data** (how it works) for all the mechanical, electrical or hydraulic devices, components and assemblies.

- Diagnostic Data (fault codes, electrical and hydraulic troubleshooting) for all the mechanical, electrical or hydraulic devices, components and assemblies.
- Service data (remove disassembly, assemble, install) for all the mechanical, electrical or hydraulic devices, components and assemblies.

Sections

Sections are grouped according to the main functions or a systems on the machine. Each Section is identified by a letter A, B, C etc. The amount of Sections included in the manual will depend on the type and function of the machine that the manual is written for. Each Section has a Contents page listed in alphabetic/numeric order. This table illustrates which Sections could be included in a manual for a particular product.

	SECTION											
	A - Distribution Systems											
	B - Power Production											
	C - Power Train											
	D - Travelling											
	E - Body and Structure											
	F - Frame Positioning											
	G - Tool Positioning											
	H - Working Arm											
	J - Tools and Couplers											
	K - Crop Processing											
	L - Field Processing											
PRODUCT												
Tractors	X	X	X	X	X	X		X	X			
Vehicles with working arms: backhoes, excavators, skid steers,	X	X	X	X	X	X	X	X	X			
Combines, forage harvesters, balers,	X	X	X	X	X	X			X	X		
Seeding, planting, floating, spraying equipment,	X	X	X	X	X	X	X		X		X	
Mounted equipment and tools,					X	X	X		X			

This manual contains these sections.

Contents

INTRODUCTION	
DISTRIBUTION SYSTEMS	A
TRAVELLING	D
WORKING ARM	H
FIELD PROCESSING	L

Your manual contains these Sections. The contents of each Section are explained over the following pages.

Section Contents

SECTION A, DISTRIBUTION SYSTEMS

Contents

DISTRIBUTION SYSTEMS - A	
PRIMARY HYDRAULIC POWER SYSTEM	A.10.A
1740, 2340, 2640, 3450, 3850, 4350	
ELECTRICAL POWER SYSTEM	A.30.A
1740, 2340, 2640, 3450, 3850, 4350	
LIGHTING SYSTEM	A.40.A
1740, 2340, 2640, 3450, 3850, 4350	
ELECTRONIC SYSTEM	A.50.A
1740, 2340, 2640, 3450, 3850, 4350	

This Section covers the main systems that interact with most of the functions of the product. It includes the central parts of the hydraulic, electrical, electronic, pneumatic, lighting and grease lubrication systems. The components that are dedicated to a specific function are listed in the Chapter where all the technical information for that function is included.

SECTION D, TRAVELLING

Contents

TRAVELLING - D

FRONT AXLE	D.10.A
1740 Tow Behind, 2340 Tow Behind, 2640 Tow Behind, 3450 Tow Behind, 3850 Tow Behind, 4350 Tow Behind	
REAR AXLE	D.12.A
1740, 2340, 2640, 3450, 3850, 4350	
WHEELS AND TRACKS Wheels	D.50.C
1740, 2340, 2640, 3450, 3850, 4350	

SECTION H, WORKING ARM

This Section covers all the functions related to moving the machine, including tracks, wheels, steering and braking. It covers all the axles both driven axles and non-driven axles, including any axle suspension.

Contents

WORKING ARM - H

HITCH Front Hitch	H.10.B
1740 Tow Behind, 2340 Tow Behind, 2640 Tow Behind, 3450 Tow Behind, 3850 Tow Behind, 4350 Tow Behind	
HITCH Rear Hitch	H.10.C
1740, 2340	

SECTION L, FIELD PROCESSING

This Section covers all the field processing functions of the machine.

Contents

FIELD PROCESSING - L

SEEDING Mechanical System	L.10.B
1740, 2340, 2640, 3450, 3850, 4350	
SEEDING Electronic System	L.10.C
1740, 2340, 2640, 3450, 3850, 4350	
SEEDING Fan System	L.10.D
1740, 2340, 2640, 3450, 3850, 4350	
SEEDING Air System	L.10.E
1740, 2340, 2640, 3450, 3850, 4350	
SEEDING Metering System	L.10.F
1740, 2340, 2640, 3450, 3850, 4350	
SEEDING Optional Tank	
1740, 2340	L.10.G

Chapters

Each Chapter is identified by a letter and number combination e.g. Field Processing L.10.C. The first letter is identical to the Section letter i.e. Chapter L.10.C is inside Section L, Field Processing. The Chapter Contents lists all the "Technical Data" (specifications), "Functional Data" (how it works), "Service Data" (remove, install adjust, etc..) and "Diagnostic Data" (fault codes and troubleshooting) that have been written in that Chapter for that function or system on the machine.

Contents

FIELD PROCESSING - L**SEEDING - Electronic system - 10.C****TECHNICAL DATA****Electronic Control**

Electronic Control - NH3 control - Calibration (L10.C92.20 - D30.A10)	6
1740, 2340, 2640, 3450, 3850, 4350	

FUNCTIONAL DATA**Command**

Command Switch box - Dynamic description (L.10.C.05.30 - C.30.A.10)	7
1740, 2340, 2640, 3450, 3850, 4350	

SERVICE

SEEDING Electronic system - Calibration (L.10.C - F.90.A.40)	32
1740, 2340, 2640, 3450, 3850, 4350	

DIAGNOSTIC

SEEDING Electronic system - Troubleshooting (L.10.C - G.40.A.10)	53
1740, 2340, 2640, 3450, 3850, 4350	

The Chapter Index lists in alphabetical order all the types of information (called Information Units) that have been written in that Chapter for that function or system on the machine.

Contents

FIELD PROCESSING - L

Command Calibration switch - Short circuit (L.10.C.05.10 - G.30.B.52)	55
---	----

1740, 2340, 2640, 3450, 3850, 4350	
Command Calibration switch - Testing (L.10.C.05.10 - G.40.A.20)	56
Command Meter Switch - Detailed view (L.10.C.05.20 - C.10.A.50)	9
Command Switch box- Detailed view (L.10.C.05.30 - C.10.A.50)	8
1740, 2340, 2640, 3450, 3850, 4350	

Information Units and Information Search

Each chapter is composed of information units. Each information unit has the ICE code shown in parentheses which indicates the function and the type of information written in that information unit. Each information unit has a page reference within that Chapter. The information units provide a quick and easy way to find just the right piece of technical information you are looking for.

example information unit	Stack valve - Sectional View (A.10.A.18 - C.10.A.30)				
Information Unit ICE code	A	10.A	18	C	10.A.30
ICE code classification	Distribution systems	Primary hydraulic power	Stack valve	Functional data	Sectional view

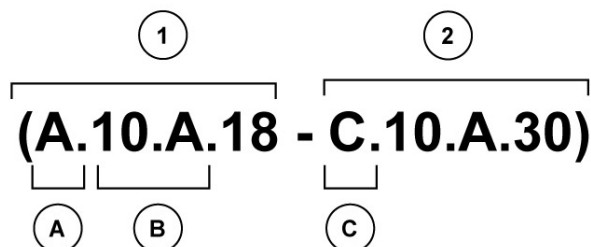

CRIL03J033E01 1

Navigate to the correct information unit you are searching for by identifying the function and information type from the ICE code.

- **(1)** Function and **(2)** Information type.
- **(A)** corresponds to the sections of the repair manual.
(B) corresponds to the chapters of the repair manual.
(C) corresponds to the type of information listed in the chapter contents, Technical data, Functional Data, Diagnostic or Service.
(A) and **(B)** are also shown in the page numbering on the page footer.
 THE REST OF THE CODING IS NOT LISTED IN ALPHA-NUMERIC ORDER IN THIS MANUAL.
- You will find a table of contents at the beginning and end of each section and chapter.
 You will find an alphabetical index at the end of each chapter.
- By referring to **(A)**, **(B)** and **(C)** of the coding, you can follow the contents or index (page numbers) and quickly find the information you are looking for.

Page Header and Footer

The page header will contain the following references:

- Section and Chapter description

The page footer will contain the following references.

GI-090V1 1 07/04/2004
A.10.A / 8

104031S1 2

Page Footer Information

Printed references found at the base of each page then equate to

- The publication number for that Manual, Section or Chapter.(GI-090V1)

- Revision number of the publication (1)
- Publication date (07/04/2004)
- Chapter reference (A.10.A)
- Page reference (8)

Decals (- A.50.A.30)

1740, 2340

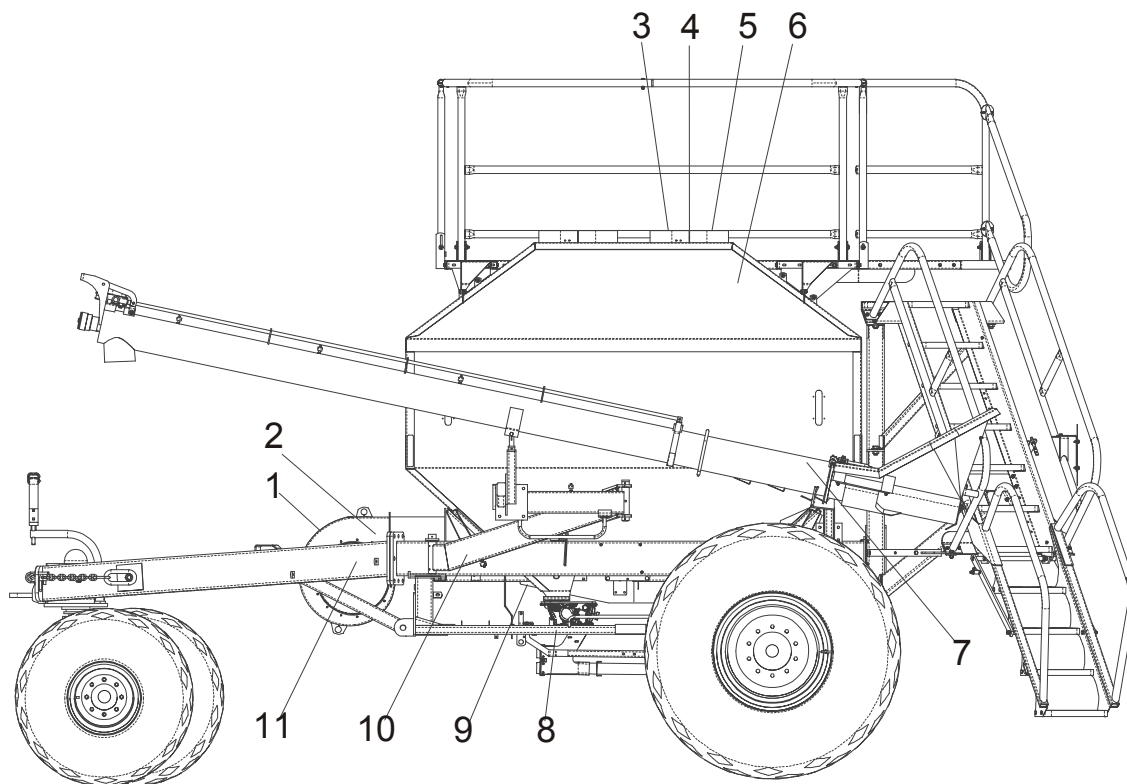

103149c1 1

Safety Decal Locations - Tow Behind Cart

Refer to the description of the decals.

1. DANGER - Danger Fan



GD50073 2

2. DANGER - Danger, Keep Shields in Place.



gl70052 3

3. WARNING - Tank Lids

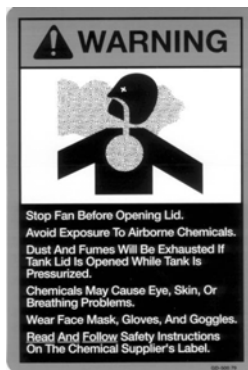

Gd50079 4

4. CAUTION - Lid Raises Automatically
(On each tank lid.)

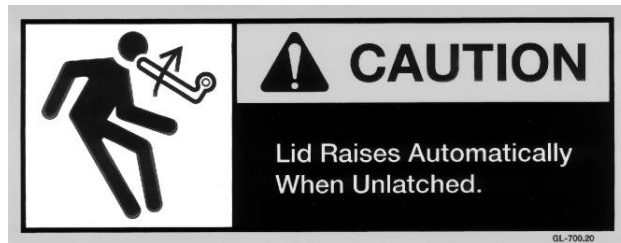

GL70020 5

5. WARNING - Do Not Ride or Stand on Tank
(On each tank lid.)

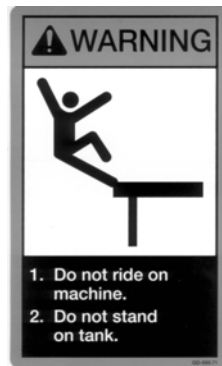

GD50071 6

6. WARNING - No Step



22767 7

7. DANGER - Auger Flying



GD50080 8

8. CAUTION - Keep Hands Clear of Manifold



GL70021 9

9. WARNING - Rotating Parts Hazard
(Right side of air cart.)



Gd50078 10

10. CAUTION - Before Operating or Servicing



GD50072 11

11. CAUTION - Escaping Fluid Hazard

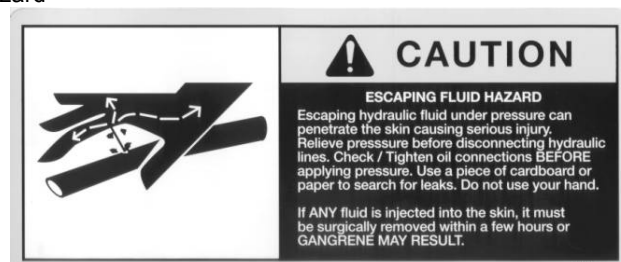

GD50077 12

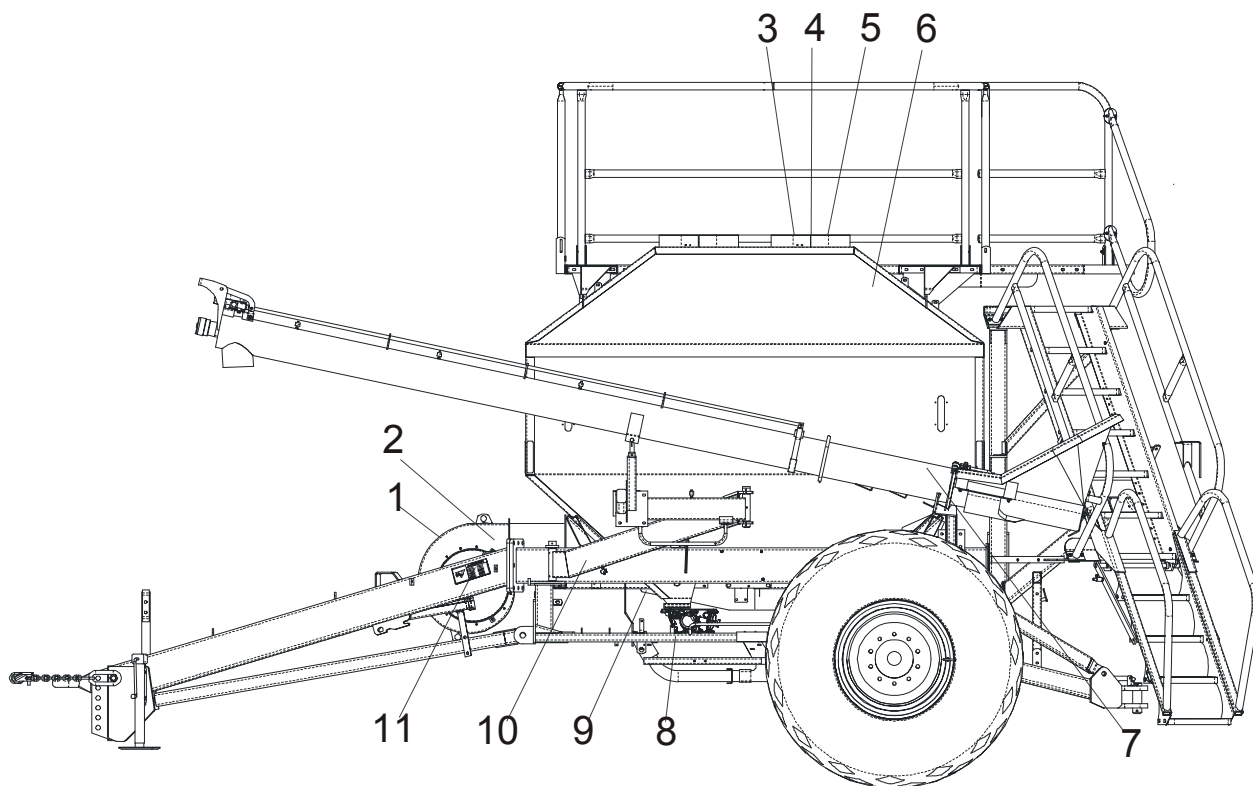

103150c1 13

Safety Decal Locations - Tow Between Air Cart

Refer to the description of the decals.

1. DANGER - Danger Fan



GD50073 14

2. DANGER - Danger, Keep Shields in Place.



g170052 15

3. WARNING - Tank Lids

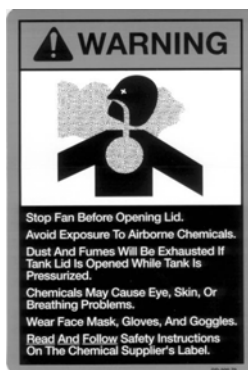

Gd50079 16

4. CAUTION - Lid Raises Automatically
(On each tank lid.)

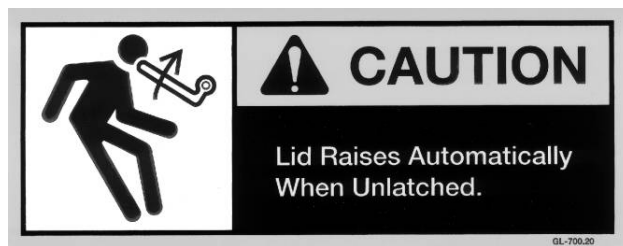

GL70020 17

5. WARNING - Do Not Ride or Stand on Tank
(On each tank lid.)

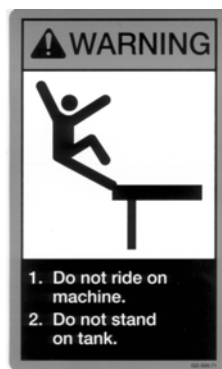

GD50071 18

6. WARNING - No Step



22767 19

7. DANGER - Auger Flying



GD50080 20

8. CAUTION - Keep Hands Clear of Manifold



GL70021 21

9. WARNING - Rotating Parts Hazard
(Right side of air cart.)



Gd50078 22

10. CAUTION - Before Operating or Servicing



GD50072 23

11. CAUTION - Escaping Fluid Hazard

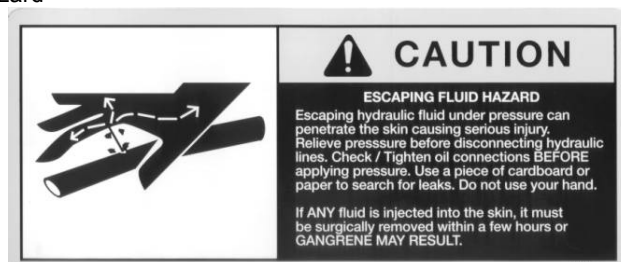

GD50077 24

12. WARNING - Loss of Control During Transport (Three point hitch only.)

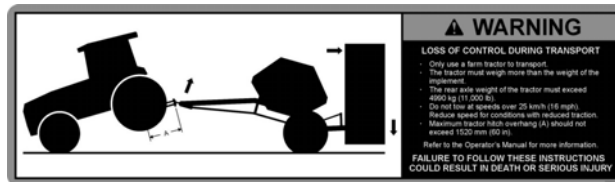

23699 25

13. WARNING - Three Point Hitch Failure Hazard (Three point hitch only.)



RC44002 26

14. DANGER - Hitch Upending Hazard (Three point hitch only.)



RC44001 27

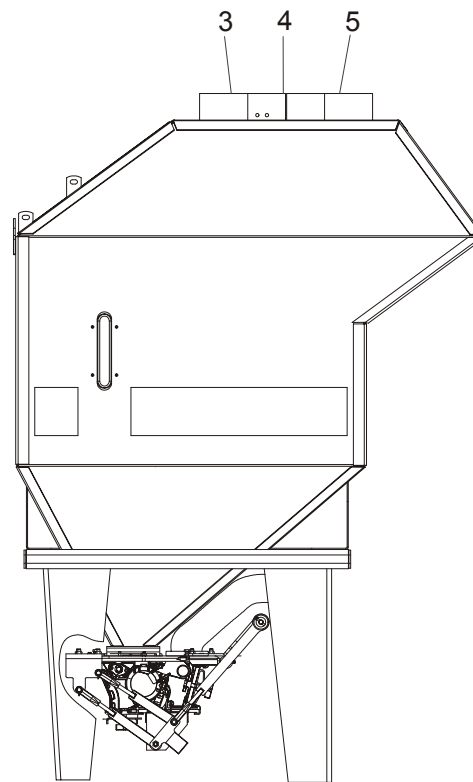

103155c1 28

Optional Third Tank - Decal Locations

Refer to the description of the decals.

- not used

2. not used
3. WARNING - Do Not Ride or Stand on Machine.

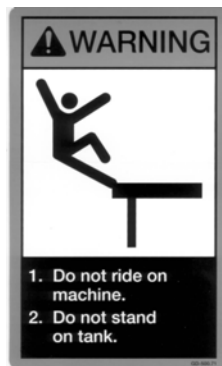

GD50071 29

4. CAUTION - Lid Raises Automatically

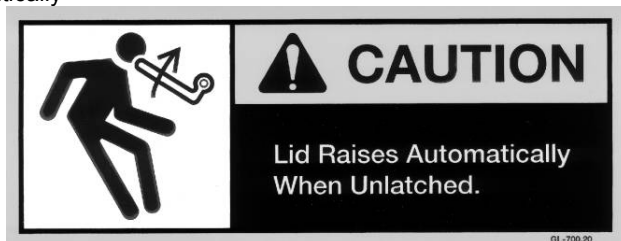

GL70020 30

5. WARNING - Fumes



Gd50079 31

Decals (- A.50.A.30)

2640

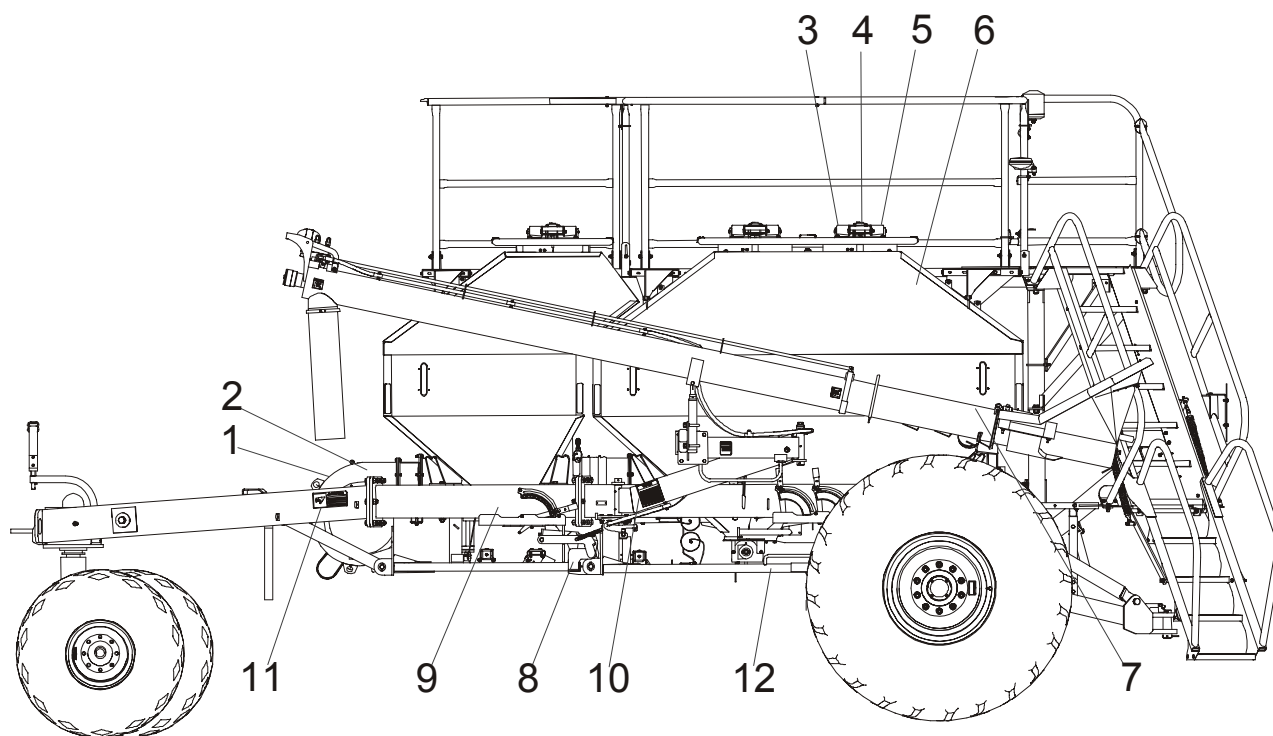

103151c1 1

Safety Decal Locations - Tow Behind Air Cart

Refer to decals for descriptions.

1. DANGER - Fan Shields



GD50073 2

2. DANGER - Keep Shields in Place



gl70052 3

3. WARNING - Fumes

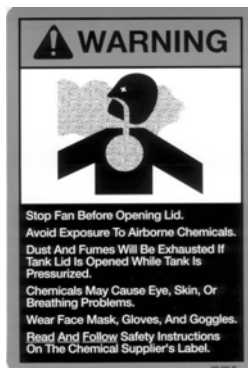

Gd50079 4

4. CAUTION - Lid Raises Automatically
(On all tank lids.)

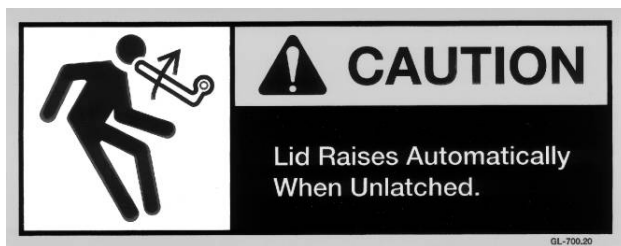

GL70020 5

5. WARNING - Do Not Stand or Ride
(On all tank lids.)



GD50071 6

6. WARNING - No Step



22767 7

7. DANGER - Flighting



GD50080 8

8. CAUTION - Keep Hands Clear of Center Manifold.



GL70021 9

9. WARNING - Rotating Parts Hazard
(Right side of air cart.)



Gd50078 10

10. CAUTION - Operation and Service



GD50072 11

11. CAUTION - Escaping Fluid Hazard

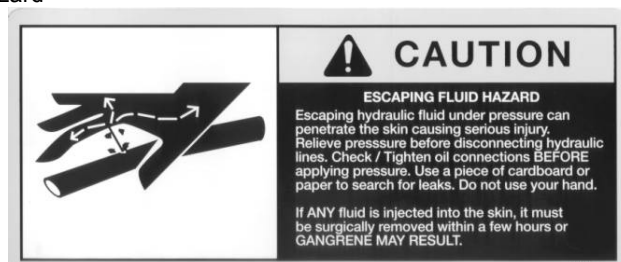

GD50077 12

12. CAUTION - Manifold is heavy.



23759 13

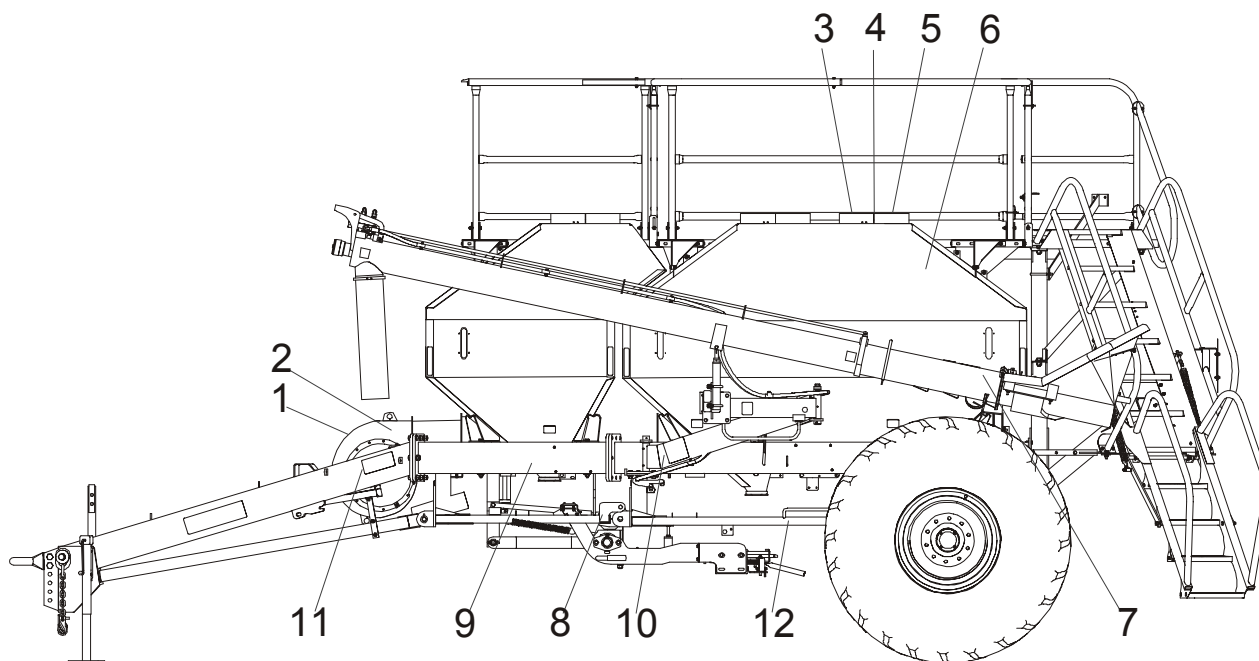

103152c1 14

Safety Decal Locations - Tow Between Air Cart

Refer to the decal descriptions.

1. DANGER - Fan Shields



GD50073 15

2. DANGER - Keep Shields in Place



gl70052 16

3. WARNING - Fumes

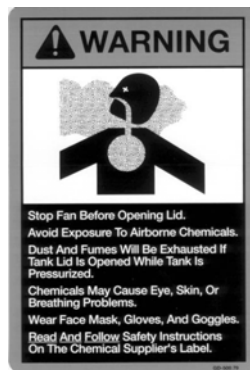

Gd50079 17

4. CAUTION - Lid Raises Automatically
(On all tank lids.)

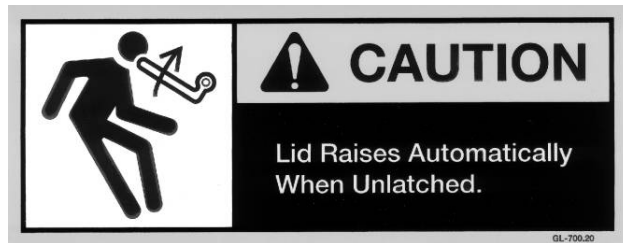

GL70020 18

5. WARNING - Do Not Stand or Ride
(On all tank lids.)

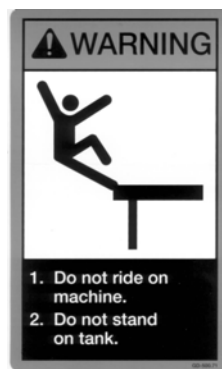

GD50071 19

6. WARNING - No Step



22767 20

7. DANGER - Auger Flighting



GD50080 21

8. CAUTION - Keep Hands Clear of Center Manifold



GL70021 22

9. WARNING - Rotating Parts Hazard
(Right side of air cart.)



Gd50078 23

10. CAUTION - Operation and Service



GD50072 24

11. CAUTION - Escaping Fluid Hazard

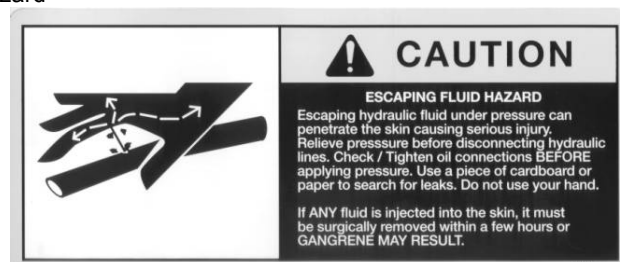

GD50077 25

12. CAUTION - Manifold is Heavy



23759 26

Product: Flexi-Coil 40 and 50 Series (1740,2340,2640,3450,3850,4350) Air Cart Service Repair Manual

Full Download: <https://www.arepairmanual.com/downloads/flexi-coil-40-and-50>

3450, 3850, 4350
Series 1740, 2340, 2640, 3450, 3850, 4350-air-cart-service-repair-manual/
al/

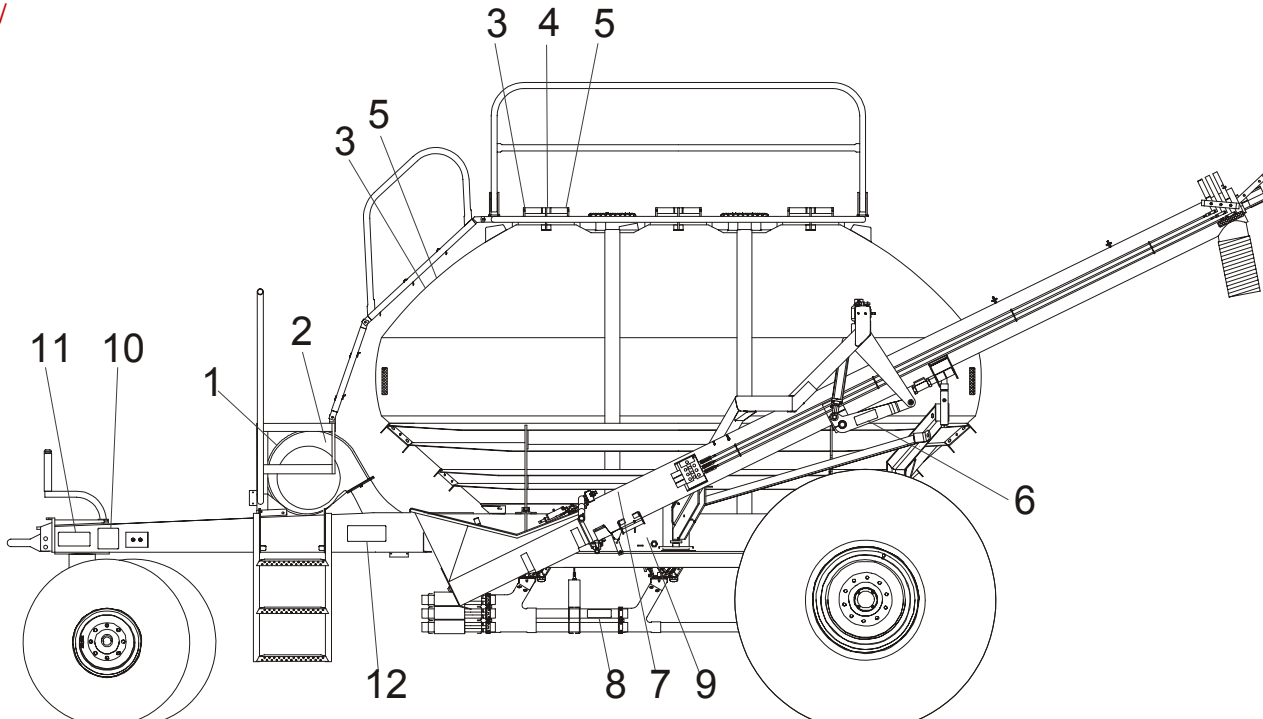

103153c1 1

Safety Decal Locations - Tow Behind Air Cart

Refer to Decal Descriptions

1. DANGER - Fan Shield



GD50073 2

2. DANGER - Keep Shields in Place



gl70052 3

3. WARNING - Fumes
(On each tank lid.)

Sample of manual. Download All 646 pages at:

<https://www.arepairmanual.com/downloads/flexi-coil-40-and-50-series174023402640345038504350-air-cart-service-repair-manual/>