



Section 2

Care and Safety

Service Manual - VMT160 VMT260

[Section 1 - General Information](#)

[Section 2 - Care and Safety](#)

[Section 3 - Maintenance](#)

[Section C - Electrics](#)

[Section E - Hydraulics](#)

[Section H - Steering](#)

[Section K - Engine](#)

[Section L - Vibration](#)



Publication No.
9803/9530-6



Sample manual. Download All pages at.

<https://www.arepairmanual.com/downloads/jcb-vmt160vmt260-roller-service-repair-manual/>

World Class
Customer Support



Section 2 - Care and Safety

Contents	Page No.
Safety Notices	
Important Information	2-1
The Operator Manual	2-1
Safety Warnings	2-1
Safety Check List	2-2
Safety - Yours and Others	2-2
General Safety	2-2
Operating Safety	2-4
Maintenance Safety	2-7
Safety Labels	2-12
Introduction	2-12
Safety Label Identification	2-13
Part Numbers and Description	2-14



Section 2 - Care and Safety

Contents

Page No.

Safety Notices

Important Information

T1-042

The Operator Manual

WARNING

You and others can be killed or seriously injured if you operate or maintain the machine without first studying the Operator Manual. You must understand and follow the instructions in the Operator Manual. If you do not understand anything, ask your employer or JCB dealer to explain it.

INT-1-4-2

Do not operate the machine without an Operator Manual, or if there is anything on the machine you do not understand.

Treat the Operator Manual as part of the machine. Keep it clean and in good condition. Replace the Operator Manual immediately if it is lost, damaged or becomes unreadable.

Safety Warnings



This safety alert system identifies important safety messages in this manual. When you see this symbol, be alert, your safety is involved, carefully read the message that follows, and inform other operators.

In this publication and on the machine, there are safety notices. Each notice starts with a signal word. The signal word meanings are given below.

DANGER

Denotes an extreme hazard exists. If proper precautions are not taken, it is highly probable that the operator (or others) could be killed or seriously injured.

INT-1-2-1

WARNING

Denotes a hazard exists. If proper precautions are not taken, the operator (or others) could be killed or seriously injured.

INT-1-2-2

CAUTION

Denotes a reminder of safety practices. Failure to follow these safety practices could result in injury to the operator (or others) and possible damage to the machine.

INT-1-2-3

Safety Check List

Safety - Yours and Others

INT-1-3-1_3

All machinery can be hazardous. When a machine is correctly operated and properly maintained, it is a safe machine to work with. But when it is carelessly operated or poorly maintained it can become a danger to you (the operator) and others.

In this manual and on the machine you will find warning messages. Read and understand them. They tell you of potential hazards and how to avoid them. If you do not fully understand the warning messages, ask your employer or JCB distributor to explain them.

But safety is not just a matter of responding to the warnings. All the time you are working on or with the machine you must be thinking what hazards there might be and how to avoid them.

Do not work with the machine until you are sure that you can control it.

Do not start any job until you are sure that you and those around you will be safe.

If you are unsure of anything, about the machine or the job, ask someone who knows. Do not assume anything.

Remember

BE CAREFUL
BE ALERT
BE SAFE

General Safety

T1-043

WARNING

To operate the machine safely you must know the machine and have the skill to use it. You must abide by all relevant laws, health and safety regulations that apply to the country you are operating in. The Operator Manual instructs you on the machine, its controls and its safe operation; it is not a training manual. If you are a new operator, get yourself trained in the skills of using a machine before trying to work with it. If you don't, you will not do your job well, and you will be a danger to yourself and others.

INT-1-4-1

WARNING

Care and Alertness

All the time you are working with or on the machine, take care and stay alert. Always be careful. Always be alert for hazards.

INT-1-3-5

WARNING

Clothing

You can be injured if you do not wear the proper clothing. Loose clothing can get caught in the machinery. Wear protective clothing to suit the job. Examples of protective clothing are: a hard hat, safety shoes, safety glasses, a well fitting overall, ear-protectors and industrial gloves. Keep cuffs fastened. Do not wear a necktie or scarf. Keep long hair restrained. Remove rings, watches and personal jewellery.

INT-1-3-6_2

WARNING

Alcohol and Drugs

It is extremely dangerous to operate machinery when under the influence of alcohol or drugs. Do not consume alcoholic drinks or take drugs before or while operating the machine or attachments. Be aware of medicines which can cause drowsiness.

INT-1-3-9_2

WARNING

Feeling Unwell

Do not attempt to operate the machine if you are feeling unwell. By doing so you could be a danger to yourself and those you work with.

8-1-2-4

WARNING

Mobile Phones

Switch off your mobile phone before entering an area with a potentially explosive atmosphere. Sparks in such an area could cause an explosion or fire resulting in death or serious injury.

Switch off and do not use your mobile phone when refuelling the machine.

INT-3-3-9

WARNING

Lifting Equipment

You can be injured if you use faulty lifting equipment. Make sure that lifting equipment is in good condition. Make sure that lifting tackle complies with all local regulations and is suitable for the job. Make sure that lifting equipment is strong enough for the job.

INT-1-3-7

WARNING

Raised Equipment

Never walk or work under raised equipment unless it is supported by a mechanical device. Equipment which is supported only by a hydraulic device can drop and injure you if the hydraulic system fails or if the control is operated (even with the engine stopped).

Make sure that no-one goes near the machine while you install or remove the mechanical device.

13-2-3-7_3

WARNING

Raised Machine

NEVER position yourself or any part of your body under a raised machine which is not properly supported. If the machine moves unexpectedly you could become trapped and suffer serious injury or be killed.

INT-3-3-7_1

DANGER

Lightning

Lightning can kill you. Do not use the machine if there is lightning in your area.

5-1-1-2

WARNING

Machine Modifications

This machine is manufactured in compliance with legislative and other requirements. It should not be altered in any way which could affect or invalidate any of these requirements. For advice consult your JCB Distributor.

INT-1-3-10_2

Operating Safety

WARNING

Machine Condition

A defective machine can injure you or others. Do not operate a machine which is defective or has missing parts. Make sure the maintenance procedures in this manual are completed before using the machine.

INT-2-1-2_2

WARNING

Machine Limits

Operating the machine beyond its design limits can damage the machine, it can also be dangerous. Do not operate the machine outside its limits. Do not try to upgrade the machine performance with unapproved modifications.

INT-2-1-4

WARNING

Engine/Steering Failure

If the engine or steering fails, stop the machine as quickly as possible. Do not operate the machine until the fault has been corrected.

INT-2-1-5

WARNING

Exhaust Gases

Breathing the machine exhaust gases can harm and possibly kill you. Do not operate the machine in closed spaces without making sure there is good ventilation. If possible, fit an exhaust extension. If you begin to feel drowsy, stop the machine at once and get into fresh air.

INT-2-1-10_2

WARNING

Work Sites

Work sites can be hazardous. Inspect the site before working on it. You could be killed or injured if the ground gives way under your machine or if piled material collapses onto it. Check for potholes and hidden debris, logs, ironwork etc. Any of these could cause you to lose control of your machine. Check for utilities such as electric cables (overhead and underground), gas and water pipes etc. Mark the positions of the underground cables and pipes. Make sure that you have enough clearance beneath overhead cables and structures.

INT-2-2-1_2

WARNING

Communications

Bad communications can cause accidents. Keep people around you informed of what you will be doing. If you will be working with other people, make sure any hand signals that may be used are understood by everybody. Work sites can be noisy, do not rely on spoken commands.

INT-2-2-3

WARNING

Parking

An incorrectly parked machine can move without an operator. Follow the instructions in the Operator Manual to park the machine correctly.

INT-2-2-4_2

WARNING

Banks and Trenches

Banked material and trenches can collapse. Do not work or drive too close to banks and trenches where there is danger of collapse.

INT-2-2-5

WARNING

Before moving the machine onto the trailer, make sure that the trailer and ramp are free from oil, grease and ice. Remove oil, grease and ice from the machine tyres. Make sure the machine will not foul on the ramp angle. See Static Dimensions in SPECIFICATION section for the minimum ground clearance of your machine.

2-2-7-5_1

WARNING

Safety Barriers

Unguarded machines in public places can be dangerous. In public places, or where your visibility is reduced, place barriers around the work area to keep people away.

INT-2-2-8

DANGER

Sparks

Explosions and fire can be caused by sparks from the exhaust or the electrical system. Do not use the machine in closed areas where there is flammable material, vapour or dust.

INT-2-2-10

WARNING

Hazardous Atmospheres

This machine is designed for use in normal out door atmospheric conditions. It should not be used in an enclosed area without adequate ventilation. Do not use the machine in a potentially explosive atmosphere, i.e. combustible vapours, gas or dust, without first consulting your JCB Distributor.

INT-2-1-14

CAUTION

Regulations

Obey all laws, work site and local regulations which affect you and your machine.

INT-1-3-3

WARNING

Practice

You or others can be killed or seriously injured if you do unfamiliar operations without first practising them. Practise away from the work site on a clear area. Keep other people away. Do not perform new operations until you are sure you can do them safely.

INT-2-1-1

WARNING

Airborne particles of light combustible material such as straw, grass, wood shavings, etc. must not be allowed to accumulate within the engine compartment or in the propshaft guards (when fitted). Inspect these areas frequently and clean at the beginning of each work shift or more often if required. Before opening the engine cover, ensure that the top is clear of debris.

5-3-1-12_3

WARNING

Keep the machine controls clean and dry. Your hands and feet could slide off slippery controls. If that happens you could lose control of the machine.

2-2-3-6

WARNING

Visibility

Accidents can be caused by working in poor visibility. Use your lights to improve visibility. Keep the road lights, windows and mirrors clean.

Do not operate the machine if you cannot see clearly.

5-1-4-7

WARNING

Electrical Power Cables

You could be electrocuted or badly burned if you get the machine or its attachments too close to electrical power cables.

You are strongly advised to make sure that the safety arrangements on site comply with the local laws and regulations concerning work near electric power lines.

Before you start using the machine, check with your electricity supplier if there are any buried power cables on the site.

There is a minimum clearance required for working beneath overhead power cables. You must obtain details from your local electricity supplier.

2-2-5-4

CAUTION

If you have an attachment which is not covered in the Operator Manual do not install it, use it or remove it until you have obtained, read and understood the pertinent information. Install attachments only on the machines for which they were designed.

5-5-1-1_2

WARNING

Use only the JCB approved attachments that are specified for your machine. Operating with non-specified attachments can overload the machine, causing possible damage and machine instability which could result in injury to yourself or others.

The use of non-approved attachments could invalidate your warranty.

2-4-5-2_1

DANGER

Working Platform

Using the machine as a working platform is hazardous; you can fall off and be killed or injured. Never use the machine as a working platform.

5-1-5-9

WARNING

The engine has exposed rotating parts. Switch OFF the engine before working in the engine compartment. Do not use the machine with the engine cover open.

5-2-6-5

WARNING

You could be killed or seriously injured if you operate a machine with a damaged or missing ROPS/FOPS. If the Roll Over Protection Structure (ROPS)/Falling Objects Protection Structure (FOPS) has been in an accident, do not use the machine until the structure has been renewed. Modifications and repairs that are not approved by the manufacturer may be dangerous and will invalidate the ROPS/FOPS certification.

INT-2-1-9_6

WARNING

Travelling at High Speeds

Travelling at high speeds can cause accidents. Do not reverse in a high gear with full throttle. Always travel at a safe speed to suit working conditions.

INT-5-3-3

WARNING

Controls

You or others can be killed or seriously injured if you operate the control levers from outside the machine. Operate the control levers only when you are correctly seated in the machine.

0179

CAUTION

Passengers

Passengers in or on the machine can cause accidents. Do not carry passengers.

INT-2-2-2_1

WARNING

Fires

If your machine is equipped with a fire extinguisher, make sure it is checked regularly. Keep it in the correct machine location until you need to use it.

Do not use water to put out a machine fire, you could spread an oil fire or get a shock from an electrical fire. Use carbon dioxide, dry chemical or foam extinguishers. Contact your nearest fire department as quickly as possible. Firefighters should use self-contained breathing apparatus.

INT-3-2-7_2

WARNING

Should the machine start to roll over, you can be crushed if you try to leave the cab. If the machine starts to roll over, do not try and jump from the cab. Stay in the cab, with your seat belt fastened.

INT-2-1-12

WARNING

Entering/Leaving

Entering or leaving the cab or canopy must only be made where steps and handrails are provided. Always face the machine when entering and leaving. Make sure the step(s), handrails and your boot soles are clean and dry. Do not jump from the machine. Do not use the machine controls as handholds, use the handrails.

INT-2-1-7_1

WARNING

Hillsides

Operating the machine on hillsides can be dangerous if proper precautions are not taken. Ground conditions can be changed by rain, snow, ice etc. Check the site carefully. Operate at a suitable slow speed on hillsides.

15-1-1-1

WARNING

Hill sides

Operating on hillsides can be dangerous, especially moving across a slope. If the slope is too steep, your machine could roll over.

15-1-1-2

Maintenance Safety

WARNING

Communications

Bad communications can cause accidents. If two or more people are working on the machine, make sure each is aware of what the others are doing. Before starting the engine make sure the others are clear of the danger areas; examples of danger areas are: the rotating blades and belt on the engine, the attachments and linkages, and anywhere beneath or behind the machine. People can be killed or injured if these precautions are not taken.

INT-3-1-5

WARNING

Repairs

If your machine does not function correctly in any way, get it repaired straight away. Neglect of necessary repairs could result in an accident or affect your health. Do not try to do repairs or any other type of maintenance work you do not understand. To avoid injury and/or damage get the work done by a specialist engineer.

GEN-1-5_2

WARNING

Metal Splinters

You can be injured by flying metal splinters when driving metal pins in or out. Use a soft faced hammer or copper pin to remove and fit metal pins. Always wear safety glasses.

INT-3-1-3_2

WARNING

Electrical Circuits

Understand the electrical circuit before connecting or disconnecting an electrical component. A wrong connection can cause injury and/or damage.

INT-3-1-4

WARNING

Fluid Under Pressure

Fine jets of fluid at high pressure can penetrate the skin. Keep face and hands well clear of fluid under pressure and wear protective glasses and gloves. Hold a piece of cardboard close to suspected leaks and then inspect the cardboard for signs of fluid. If fluid penetrates your skin, get medical help immediately.

INT-3-1-10_3

WARNING

Hydraulic Pressure

Hydraulic fluid at system pressure can injure you. Before connecting or removing any hydraulic hose, residual hydraulic pressure trapped in the service hose line must be vented. Make sure the hose service line has been vented before connecting or removing hoses. Make sure the engine cannot be started while the hoses are open.

INT-3-1-11_2

WARNING

Fuel

Fuel is flammable; keep naked flames away from the fuel system. Stop the engine immediately if a fuel leak is suspected. Do not smoke while refuelling or working on the fuel system. Do not refuel with the engine running. Completely wipe off any spilt fuel which could cause a fire. There could be a fire and injury if you do not follow these precautions.

INT-3-2-2_3

WARNING

Oil

Oil is toxic. If you swallow any oil, do not induce vomiting, seek medical advice. Used engine oil contains harmful contaminants which can cause skin cancer. Do not handle used engine oil more than necessary. Always use barrier cream or wear gloves to prevent skin contact. Wash skin contaminated with oil thoroughly in warm soapy water. Do not use petrol, diesel fuel or paraffin to clean your skin.

INT-3-2-3

CAUTION

It is illegal to pollute drains, sewers or the ground. Clean up all spilt fluids and/or lubricants.

Used fluids and/or lubricants, filters and contaminated materials must be disposed of in accordance with local regulations. Use authorised waste disposal sites.

INT-3-2-14

WARNING

Soft Ground

A machine can sink into soft ground. Never work under a machine on soft ground.

INT-3-2-4

WARNING

Always wear safety glasses when dismantling assemblies containing components under pressure from springs. This will protect against eye injury from components accidentally flying out.

GEN-6-2

CAUTION

Rams

The efficiency of the rams will be affected if they are not kept free of solidified dirt. Clean dirt from around the rams regularly. When leaving or parking the machine, close all rams if possible to reduce the risk of weather corrosion.

INT-3-2-10

CAUTION

Cleaning

Cleaning metal parts with incorrect solvents can cause corrosion. Use only recommended cleaning agents and solvents.

INT-3-2-11

WARNING

When using cleaning agents, solvents or other chemicals, you must adhere to the manufacturer's instructions and safety precautions.

GEN-1-9

CAUTION

'O' rings, Seals and Gaskets

Badly fitted, damaged or rotted 'O' rings, seals and gaskets can cause leakages and possible accidents. Renew whenever disturbed unless otherwise instructed. Do not use Trichloroethane or paint thinners near 'O' rings and seals.

INT-3-2-12

WARNING

Hydraulic Hoses

Damaged hoses can cause fatal accidents. Inspect the hoses regularly. Do not use the machine if a hose or hose fitting is damaged.

INT-3-3-2_4

CAUTION

Waxoyl contains turpentine substitute which is flammable. Keep flames away when applying Waxoyl. Waxoyl can take a few weeks to dry completely. Keep flames away during the drying period.

Do not weld near the affected area during the drying period. Take the same precautions as for oil to keep Waxoyl off your skin. Do not breathe the fumes. Apply in a well-ventilated area.

5-3-1-9

WARNING

Working Under the Machine

Make the machine safe before getting beneath it. Ensure that any fitments on the machine are secure; engage the park brake, remove the starter key, disconnect the battery.

INT-3-3-8_2

WARNING

Certain seals and gaskets (e.g. crankshaft oil seal) on JCB machines contain fluoroelastomeric materials such as Viton®, Fluorel™ and Technoflon®. Fluoroelastomeric materials subjected to high temperatures can produce highly corrosive hydrofluoric acid. **THIS ACID CAN SEVERELY BURN.**

New fluoroelastomeric components at ambient temperature require no special safety precautions.

Used fluoroelastomeric components whose temperatures have not exceeded 300°C (572°F) require no special safety precautions. If evidence of decomposition (e.g. charring) is found, refer to the next paragraph for safety instructions **DO NOT TOUCH COMPONENT OR SURROUNDING AREA.**

Used fluoroelastomeric components subjected to temperatures greater than 300°C (572°F) (e.g. engine fire) must be treated using the following safety procedure. Make sure that heavy duty gloves and special safety glasses are worn:

- 1 Thoroughly wash contaminated area with 10% calcium hydroxide or other suitable alkali solution, if necessary use wire wool to remove burnt remains.
- 2 Thoroughly wash contaminated area with detergent and water.
- 3 Contain all removed material, gloves etc. used in this operation in sealed plastic bags and dispose of in accordance with Local Authority Regulations.

DO NOT BURN FLUOROELASTOMERIC MATERIALS.

INT-3-3-5_4

WARNING

Protect your eyes when grinding metal. Wear safety glasses or goggles. Remove or protect any combustible materials from the area which could be ignited by sparks.

GEN-1-12

WARNING

To avoid burning, wear protective gloves when handling hot components. To protect your eyes, wear goggles when using a brush to clean components.

HYD-1-3_2

WARNING

Arc Welding

To prevent the possibility of damage to electronic components, disconnect the battery and the alternator before arc-welding on the machine or attached implements.

If the machine is equipped with sensitive electrical equipment, i.e. amplifier drivers, electronic control units (E.C.U.s), monitor displays, etc., then disconnect them before welding. Failure to disconnect the sensitive electrical equipment could result in irreparable damage to these components.

Parts of the machine are made from cast iron; welds on cast iron can weaken the structure and break. Do not weld cast iron. Do not connect the welder cable or apply any weld to any part of the engine.

Always connect the welder earth (ground) cable to the same component that is being welded, i.e. boom or dipper, to avoid damage to pivot pins, bearings and bushes. Attach the welder earth (ground) cable no more than 0.6 metres (2 feet) from the part being welded.

INT-3-1-15_2

WARNING

Counterweights

Your machine may be fitted with counterweights. They are extremely heavy. Do not attempt to remove them.

INT-3-2-5

WARNING

Compressed air is dangerous. Wear suitable eye protection and gloves. Never point a compressed air jet at yourself or others.

0147_1

WARNING

Petrol

Do not use petrol in this machine. Do not mix petrol with the diesel fuel; in storage tanks the petrol will rise to the top and form flammable vapours.

INT-3-1-6

WARNING

The cooling system is pressurised when the coolant is hot. When you remove the cap, hot coolant can spray out and burn you. Make sure that the engine is cool before you work on the cooling system.

9-3-3-1_2

CAUTION

Do not disconnect the battery while the engine is running, otherwise the electrical circuits may be damaged.

INT-3-1-14

WARNING

If you try to charge a frozen battery, or jump start and run the engine, the battery could explode. Do not use a battery if its electrolyte is frozen. To prevent the battery electrolyte from freezing, keep the battery at full charge.

0125

WARNING

Battery Gases

Batteries give off explosive gases. Keep flames and sparks away from the battery. Do not smoke close to the battery. Make sure there is good ventilation in closed areas where batteries are being used or charged. Do not check the battery charge by shorting the terminals with metal; use a hydrometer or voltmeter.

INT-3-1-8

DANGER

Electrolyte

Battery electrolyte is toxic and corrosive. Do not breathe the gases given off by the battery. Keep the electrolyte away from your clothes, skin, mouth and eyes. Wear safety glasses.

INT-3-2-1_3

 WARNING

Battery Terminals

The machine is negatively earthed. Always connect the negative pole of the battery to earth.

When connecting the battery, connect the earth (-) lead last.

When disconnecting the battery, disconnect the earth (-) lead first.

INT-3-1-9

 WARNING

Turning the Engine

Do not try to turn the engine by pulling the fan or fan belt. This could cause injury or premature component failure.

0094

Safety Labels

Introduction

T1-014_2

WARNING

Safety Labels

Safety labels on the machine warn you of particular hazards. You can be injured if you do not obey the safety instructions shown.

INT-1-3-11

Safety labels are strategically placed around the machine to remind you of possible hazards.

If you need eye-glasses for reading, make sure you wear them when reading the safety labels. Do not over-stretch or place yourself in dangerous positions to read the safety labels. If you do not understand the hazard shown on the safety label, then refer to **Safety Label Identification**.

Note: *The illustration(s) show a typical machine model. Your machine may look different from the model shown.*

Keep all safety labels clean and readable. Replace lost or damaged safety labels. Make sure replacement parts include safety labels where necessary. Each safety label has a part number printed on it, use this number to order a new safety label from your JCB distributor.

Safety Label Identification

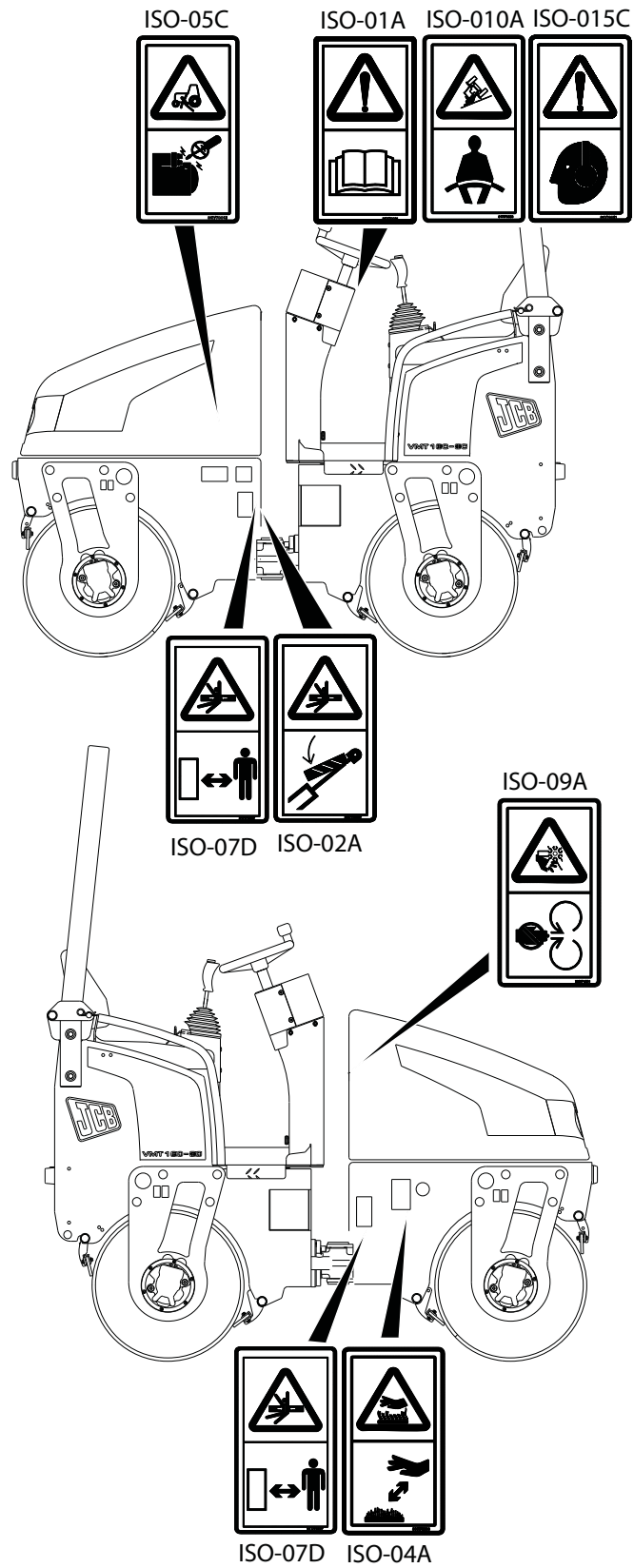

Fig 1.

T047550

Part Numbers and Description

ISO-01A

Part Number: 817/70014

Description: Warning. Read the operator manual before you operate the machine.



817-70014-3

ISO-02A

Part Number: 817/70028

Description: Crush of whole body. Install the articulation lock before you start maintenance work or transport the machine..



817-70028-2

ISO-04A

Part Number: 817/70004

Description: Burns to fingers and hands. Stay a safe distance away.



817-70004-4

ISO-05C

Part Number: 817/70012

Description: Runover. Start the engine from the operator seat only. Do not short across the terminals.



817-70012-2

ISO-07D

Part Number: 817/70027

Description: Crush hazard. Keep a safe distance from the moving parts.



817-70027-2

ISO-09A

Part Number: 332/P4581

Description: Severing of hands or fingers. Keep clear of/do not reach into the moving parts. Stop the engine and remove the starter key before you start maintenance work. Refer to **Making the Machine Safe (Routine Maintenance Section)**.



332-P4581-1

ISO-010A

Part Number: 817/70029

Description: Crush hazard. Wear the seatbelt when you operate the machine.



817-70029-3

ISO-015C

Part Number: 817/70021

Description: Noise warning. Wear applicable ear protection.

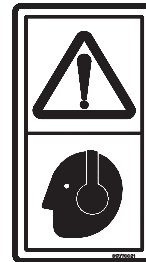

817-70021-2