



Section A

Attachments

Service Manual - Skid Steer Large Platform

[Section 1 - General Information](#)

[Section 2 - Care and Safety](#)

[Section 3 - Maintenance](#)

[Section A - Attachments](#)

[Section B - Body and Framework](#)

[Section C - Electrics](#)

[Section E - Hydraulics](#)

[Section F - Transmission](#)

[Section J - Tracks](#)

[Section K - Engine](#)



Publication No.
9803/9950-1



Sample manual. Download All pages at.

<https://www.arepairmanual.com/downloads/jcb-skid-steer-large-platform-loader-service-repair-manual/>

World Class
Customer Support



Section A - Attachments

Contents	Page No.
Optional Attachments	
Introduction	A-1
Attachments For Your Machine	A-2
Impact Protection	A-11
Connecting/Disconnecting Hydraulic Hoses	A-12
Introduction	A-12
Connecting the Hydraulic Hoses	A-12
Disconnecting the Hydraulic Hoses	A-13
Quick Release Couplings	A-14
Quickhitch Control	A-16
Engaging the Shovel/Attachments	A-16
Disengaging the Shovel/Attachments	A-18
Attachment Frame	A-19
Installation and Removal	A-19
Shovels	A-20
6-in-1 Shovel	A-20
Grapple Bucket	A-23
Installation and Removal	A-24
Operation	A-25
Maintenance	A-25
Storage	A-25
Pallet Forks	A-26
Installation and Removal	A-26
Operation	A-26
Road Travel	A-26
Maintenance	A-26
Manure/Silage Fork with Top Grab	A-27
Installation and Removal	A-27
Operation	A-27
Preparing for Travel	A-27
Maintenance	A-27
Snow Blade	A-28
Installation and Removal	A-28
Operation	A-28
Maintenance	A-29



Section A - Attachments

Contents

Page No.

Optional Attachments

Introduction

T4-002_3

WARNING

Use only the JCB approved attachments that are specified for your machine. Operating with non-specified attachments can overload the machine, causing possible damage and machine instability which could result in injury to yourself or others.

The use of non-approved attachments could invalidate your warranty.

2-4-5-2_1

CAUTION

If you have an attachment which is not covered in the Operator Manual do not install it, use it or remove it until you have obtained, read and understood the pertinent information. Install attachments only on the machines for which they were designed.

5-5-1-1_2

A wide range of optional attachments are available to increase the versatility of your machine. Only JCB approved attachments are recommended for use with your machine. Consult your JCB Distributor for the full list of approved attachments available.

This part of the manual includes general information on attachment operation and instructions for installation and removal of attachments.

Some attachments are supplied complete with instructions on safety, installing and removing, operation and maintenance. Read and fully understand the information before fitting, using and servicing the attachment. If there is anything you do not understand, ask your JCB Distributor.

Before using any attachment, read again **Working With The Machine** in the Operation section and consider how the attachment is going to affect operational safety. With the attachment fitted, there may be changes in the machine's centre of gravity or overall dimensions. This could have an effect on, for example, machine stability, the gradients on which it is safe to operate or the safe distance from power lines.

Practice using attachments off the job before working with them for the first time.

JCB attachments are designed and manufactured specifically to suit the machine's hydraulic system, mounting arrangements and safe load requirements. Attachments which are not designed for use with this machine may cause damage and create safety hazards for which JCB cannot be held responsible. In addition the machine's warranty and any other legislative compliance may be affected by the use of non JCB approved attachments.

If your machine needs the hydraulic system adapting to facilitate the use of auxiliary attachments, you must consult your distributor. Only suitably qualified personnel must re-route hydraulic hoses.

All optional attachments will have limits on their operation. i.e. lifting capacity, speeds, hydraulic flow rates, etc. Always check in the literature supplied with the attachment or in the Specification section of this manual. Some specification limits may also be displayed on the attachments Data/Rating Plate.

CAUTION

Some attachments may contact parts of the machine when in the fully folded position. Take extra care to avoid damage to the machine.

3-4-1-4



Attachments For Your Machine

Before selecting an attachment for use, assess the application and select the appropriate attachment. The density of any materials being handled will affect the selection of the appropriate attachment.

Remember, do not operate attachments until you have read and fully understand the attachment operating instructions.

⚠ CAUTION

If you have an attachment which is not covered in the Operator Manual do not install it, use it or remove it until you have obtained, read and understood the pertinent information. Install attachments only on the machines for which they were designed.

These attachments will help increase the productivity of your machine, for more information contact your JCB Distributor.

Do not operate or work with attachments until the machine hydraulic oil has reached its normal working temperature.

5-5-1-1_2

Table 1. Dirt/GP Buckets

Part #	Item	JCB Model Name	260	280	300	330	260T	300T	320T
332/X3184	66" Dirt/GP Bucket / 14.1 cu. ft. Capacity	DB66	*	*	*				
332/L1798	72" Dirt/GP Bucket / 15.4 cu. ft. Capacity	DB72	*	*	*				
332/X3180	78" Dirt/GP Bucket / 16.7 cu. ft. Capacity	DB78	*	*	*	*	*	*	*
332/L1825	84" Dirt/GP Bucket / 18.1 cu. ft. Capacity	DB84	*	*	*	*	*	*	*
332/L1831	84" Extra High Capacity / Very Light Material Bucket / 43.9 cu. ft. Capacity	HCB84	*	*	*	*	*	*	*
332/L1834	96" Extra High Capacity / Very Light Material Bucket / 54 cu. ft. Capacity	HCB96	*	*	*	*	*	*	*

Table 2. Landscape Buckets

Part #	Item	JCB Model Name	260	280	300	330	260T	300T	320T
332/L1826	66" Landscape Bucket / 17.5 cu. ft. Capacity	LSB66	*	*	*				
332/L1827	72" Landscape Bucket / 19.2 cu. ft. Capacity	LSB72	*	*	*				
332/L1828	78" Landscape Bucket / 20.9 cu. ft. Capacity	LSB78	*	*	*	*	*	*	*
332/X3214	84" Landscape Bucket / 22.7 cu. ft. Capacity	LSB84	*	*	*	*	*	*	*



Section A - Attachments Optional Attachments

Attachments For Your Machine

Table 3. High Capacity / Light Material Buckets

Part #	Item	JCB Model Name	260	280	300	330	260T	300T	320T
332/L1829	75" High Capacity / Light Material Bucket / 21 cu. ft. Capacity	LMB75	*	*	*	*			
332/L1830	84" High Capacity / Light Material Bucket / 26.8 cu. ft. Capacity	LMB84	*	*	*	*	*	*	*
332/L1831	84" Extra High Capacity / Very Light Material Bucket / 43.9 cu. ft. Capacity	HCB84	*	*	*	*	*	*	*
332/L1834	96" Extra High Capacity / Very Light Material Bucket / 54 cu. ft. Capacity	HCB96	*	*	*	*	*	*	*

Table 4. Snow Buckets

Part #	Item	JCB Model Name	260	280	300	330	260T	300T	320T
332/X4311	84" Medium Duty Snow Bucket / 30.8 cu. ft. Capacity	MSB84	*	*					
332/X4312	96" Medium Duty Snow Bucket / 35.4 cu. ft. Capacity	MSB96	*	*					
332/X4313	96" Heavy Duty Snow Bucket / 49.4 cu. ft. Capacity	"HSB96	*	*	*	*	*	*	*
332/X4314	108" Heavy Duty Snow Bucket / 55.9 cu. ft. Capacity	HSB108	*	*	*	*	*	*	*

Table 5. 6 in 1 Multipurpose Buckets

Part #	Item	JCB Model Name	260	280	300	330	260T	300T	320T
332/X4315	66" - 6 in 1 Multipurpose Bucket / 15.8 cu. ft. Capacity	MPB66	*	*	*				
332/L3338	72" - 6 in 1 Multipurpose Bucket / 17.2 cu. ft. Capacity	MPB72	*	*	*				
332/L3339	78" - 6 in 1 Multipurpose Bucket / 21.7 cu. ft. Capacity	MPB78	*	*	*	*	*	*	*
332/L3340	84" - 6 in 1 Multipurpose Bucket / 23.4 cu. ft. Capacity	MPB84	*	*	*	*	*	*	*

Table 6. Bucket Accessories

Part #	Item	JCB Model Name	260	280	300	330	260T	300T	320T
332/L3514	Bolt on Edge for 66" bucket		*	*	*				
332/L3516	Bolt on Edge for 72" bucket		*	*	*				
332/L3518	Bolt on Edge for 78" bucket		*	*	*	*	*	*	*
332/L3519	Bolt on Edge for 84" bucket		*	*	*	*	*	*	*
332/L3521	Tooth Bar for 66" bucket - Over bucket		*	*	*				



Section A - Attachments Optional Attachments

Attachments For Your Machine

Part #	Item	JCB Model Name	260	280	300	330	260T	300T	320T
332/L3532	Tooth Bar for 72" bucket - Over bucket		*	*	*				
332/L3535	Tooth Bar for 78" bucket - Over bucket		*	*	*	*	*	*	*
332/L3561	Tooth Bar for 84" bucket - Over bucket		*	*	*	*	*	*	*
332/L3529	Tooth Bar for 66" bucket - Over bolt on edge		*	*	*				
332/L3533	Tooth Bar for 72" bucket - Over bolt on edge		*	*	*				
332/L3536	Tooth Bar for 78" bucket - Over bolt on edge		*	*	*	*	*	*	*
332/L3563	Tooth Bar for 84" bucket - Over bolt on edge		*	*	*	*	*	*	*

Table 7. Pallet Forks

Part #	Item	JCB Model Name	260	280	300	330	260T	300T	320T
332/L3341	Pallet Fork Frame, Load backrest and 42" Tines	"PF42	*	*	*	*	*	*	*
332/L3342	Pallet Fork Frame, Load backrest and 48" Tines	"PF48	*	*	*	*	*	*	*

Table 8. Grapple Attachments

Part #	Item	JCB Model Name	260	280	300	330	260T	300T	320T
332/X4316	66" Brush Grapple		*	*	*				
332/X4317	72" Brush Grapple		*	*	*				
332/X4318	66" Scrap Grapple (solid floor)		*	*	*				
332/X4319	"72" Scrap Grapple (solid floor)		*	*	*				
332/L4030	72" Heavy Duty Brush Grapple	HBG72	*	*	*				
332/L4033	78" Heavy Duty Brush Grapple	HBG78	*	*	*	*	*	*	*
332/L4035	84" Heavy Duty Brush Grapple	HBG84	*	*	*	*	*	*	*
332/L4036	76" Heavy Duty Scrap Grapple (solid floor)	HSG76	*	*	*	*			
332/L4039	82" Heavy Duty Scrap Grapple (solid floor)	HSG82	*	*	*	*	*	*	*
332/X4321	66" Heavy Duty Forked Scrap Grapple	FSG66	*	*	*				
332/X4322	72" Heavy Duty Forked Scrap Grapple	FSG72	*	*	*				
332/X4323	78" Heavy Duty Forked Scrap Grapple	FSG78	*	*	*	*	*	*	*



Section A - Attachments Optional Attachments

Attachments For Your Machine

Part #	Item	JCB Model Name	260	280	300	330	260T	300T	320T
332/X4324	84" Heavy Duty Forked Scrap Grapple	FSG84	*	*	*	*	*	*	*

Table 9. Hydraulic Brooms/Sweepers

Part #	Item	JCB Model Name	260	280	300	330	260T	300T	320T
980/A4034	72" Pick-Up Sweeper	SC180	*	*	*	*	*	*	*
980/A6731	82" Pick-Up Sweeper	SC214	*	*	*	*	*	*	*
980/A4677	Gutter Brush - Left or Right Head for 72" & 82" Pick Up Sweepers		*	*	*	*	*	*	*
980/89426	Sprinkler Kit for 72" or 82" Pick Up Sweeper		*	*	*	*	*	*	*
332/L3992	Angle broom - 72" with manual angle adjustment link	BR72	*	*	*				
332/L4027	Angle broom - 84" with manual angle adjustment link	BR84	*	*	*	*	*	*	*
332/L3983	Hydraulic angle kit for 72" or 84" Angle Broom		*	*	*	*	*	*	*

Table 10. Hammers

Part #	Item	JCB Model Name	260	280	300	330	260T	300T	320T
980/90369	HM265Q (includes Chisel & Moil) - *980/28400 Mounting Bracket required*	HM265Q	*	*	*	*	*	*	*
980/28400	Mounting Plate - Required for HM265Q Hammer		*	*	*	*	*	*	*
980/A3483	HM386Q (includes Chisel & Moil) - *980/68700 Mounting Bracket required*	HM386Q	*	*	*	*	*	*	*
980/68700	Mounting Plate - Required for HM386Q Hammer		*	*	*	*	*	*	*

Table 11. Auger Drive Units

Part #	Item	JCB Model Name	260	280	300	330	260T	300T	320T
332/L3978	Planetary Drive Auger - Standard Flow - (includes mounting bracket & hoses)	PASF	*	*	*	*	*	*	*
332/L3979	Planetary Drive Auger - HIGH FLOW - (includes mounting bracket & hoses)	PAHF	*	*	*	*	*	*	*



Section A - Attachments Optional Attachments

Attachments For Your Machine

Table 12. Auger Bits - Standard Duty

Part #	Item	JCB Model Name	260	280	300	330	260T	300T	320T
980/A2019	6" X 4' Standard Auger 2" Hex		*	*	*	*	*	*	*
980/A2021	9" X 4' Standard Auger 2" Hex		*	*	*	*	*	*	*
980/A2023	12" X 4' Standard Auger 2" Hex		*	*	*	*	*	*	*
980/A2025	15" X 4' Standard Auger 2" Hex		*	*	*	*	*	*	*
980/A2027	18" X 4' Standard Auger 2" Hex		*	*	*	*	*	*	*
980/A2028	24" X 4' Standard Auger 2" Hex		*	*	*	*	*	*	*
980/A2029	30" X 4' Standard Auger 2" Hex		*	*	*	*	*	*	*
980/A2030	36" X 4' Standard Auger 2" Hex		*	*	*	*	*	*	*

Table 13. Auger Bits - Heavy Duty

Part #	Item	JCB Model Name	260	280	300	330	260T	300T	320T
985/00054	6" X 4' Heavy Duty Auger 2" Hex		*	*	*	*	*	*	*
980/A2031	9" X 4' Heavy Duty Auger 2" Hex		*	*	*	*	*	*	*
980/A2032	12" X 4' Heavy Duty Auger 2" Hex		*	*	*	*	*	*	*
980/A2034	15" X 4' Heavy Duty Auger 2" Hex		*	*	*	*	*	*	*
980/A2035	18" X 4' Heavy Duty Auger 2" Hex		*	*	*	*	*	*	*
980/A2037	24" X 4' Heavy Duty Auger 2" Hex		*	*	*	*	*	*	*
980/A2038	30" X 4' Heavy Duty Auger 2" Hex		*	*	*	*	*	*	*
980/A2039	36" X 4' Heavy Duty Auger 2" Hex		*	*	*	*	*	*	*

Table 14. Auger Bits - Tree & Shrub

Part #	Item	JCB Model Name	260	280	300	330	260T	300T	320T
985/00062	18" X 4' Tree & Shrub Planting Auger 2" Hex		*	*	*	*	*	*	*
985/00063	24" X 4' Tree & Shrub Planting Auger 2" Hex		*	*	*	*	*	*	*
985/00064	30" X 4' Tree & Shrub Planting Auger 2" Hex		*	*	*	*	*	*	*
985/00016	36" X 4' Tree & Shrub Planting Auger 2" Hex		*	*	*	*	*	*	*

Table 15. Auger Extensions

Part #	Item	JCB Model Name	260	280	300	330	260T	300T	320T
985/00066	Hex. Drive Extension - 12"		*	*	*	*	*	*	*
985/00066	Hex. Drive Extension - 18"		*	*	*	*	*	*	*
985/00067	Hex. Drive Extension - 24"		*	*	*	*	*	*	*



Section A - Attachments Optional Attachments

Attachments For Your Machine

Table 16. Landscape Development Tools

Part #	Item	JCB Model Name	260	280	300	330	260T	300T	320T
332/L3939	72" Landscape Power Rake with Manual Angle	PRM72	*	*	*	*	*	*	*
332/L3947	72" Landscape Power Rake with Hydraulic Angle	PRH72	*	*	*	*	*	*	*
332/X4327	84" Landscape Power Rake with Manual Angle	PRM84	*	*	*	*	*	*	*
332/L3951	84" Landscape Power Rake with Hydraulic Angle	PRH84	*	*	*	*	*	*	*
332/X4329	90" Landscape Power Rake with Manual Angle	PRM90	*	*	*	*	*	*	*
332/X4330	90" Landscape Power Rake with Hydraulic Angle	PRH90	*	*	*	*	*	*	*
334/X4332	66" Landscape Preperator - Standard Flow	LSP66	*	*	*	*	*	*	*
332/L3954	76" Landscape Preperator - Standard Flow	LSP76	*	*	*	*	*	*	*
332/X4331	66" Auto Rake - Standard Flow	AR66	*	*	*	*			
332/L3960	76" Auto Rake - Standard Flow	AR76	*	*	*	*	*	*	*
332/X4380	66" Tiller - 6 inch tines - HIGH FLOW	TLR66HF	*	*	*	*	*	*	*
332/X4381	78" Tiller - 6 inch tines - HIGH FLOW	TLR78HF	*	*	*	*	*	*	*
332/X4281	73" Vibratory Roller - Smooth Drum	VR73S	*	*	*	*	*	*	*
332/X4282	84" Vibratory Roller - Smooth Drum	VR84S	*	*	*	*	*	*	*
332/X4283	73" Vibratory Roller - Padded Drum	VR73P	*	*	*	*	*	*	*
332/X4284	84" Vibratory Roller - Padded Drum	VR84P	*	*	*	*	*	*	*

Table 17. Dirt/GP Buckets Forestry Cutters **REQUIRES FORESTRY GUARDS**

Part #	Item	JCB Model Name	260	280	300	330	260T	300T	320T
332/X4371	60" Forestry Cutting Head - HIGH FLOW - **REQUIRES FORESTRY GUARDS**	FC60HF	*	*	*	*	*	*	*
332/X4339	72" Forestry Cutting Head - HIGH FLOW - **REQUIRES FORESTRY GUARDS**	FC72HF			*	*		*	*



Section A - Attachments Optional Attachments

Attachments For Your Machine

Table 18. Dozer Blades - Controls Required- Adaptor Harness

Part #	Item	JCB Model Name	260	280	300	330	260T	300T	320T
332/X4285	84" Dozer Blade - 6 Way Hydraulic	HDB84	*	*	*	*	*	*	*
332/X4287	96" Dozer Blade - 6 Way Hydraulic	HDB96			*	*	*	*	*

Table 19. Agricultural Attachments

Part #	Item	JCB Model Name	260	280	300	330	260T	300T	320T
332/L3869	72" Manure Forks with Top Grapple	MFG72	*	*					
332/L3879	84" Manure Forks with Top Grapple	MFG84	*	*	*	*	*	*	*
332/X4338	96" Silage Defacer - Standard Flow	SD96	*	*	*	*	*	*	*

Table 20. Trenchers

Part #	Item	JCB Model Name	260	280	300	330	260T	300T	320T
332/X4288	36" Trencher with 6" wide chain, crumber and hoses - Standard Flow	TR36	*	*	*	*	*	*	*
332/X4289	48" Trencher with 6" wide chain, crumber and hoses - Standard Flow	TR48	*	*	*	*	*	*	*
332/X4290	48" Trencher with 6" wide chain, crumber and hoses - HIGH FLOW	TR48HF	*	*	*	*	*	*	*

Table 21. Brush Cutters

Part #	Item	JCB Model Name	260	280	300	330	260T	300T	320T
332/X4291	72" Brush Cutter - Standard Flow	BC72	*	*	*	*	*	*	*
332/X4292	72" Brush Cutter - HIGH FLOW	BC72HF	*	*	*	*	*	*	*
332/X4293	78" Brush Cutter - HIGH FLOW	BC78HF	*	*	*	*	*	*	*

Table 22. Stump Grinders - Controls Requirements - Box & Harness

Part #	Item	JCB Model Name	260	280	300	330	260T	300T	320T
332/X4294	Stump Grinder - 26" Wheel Diameter / Standard Flow	SGS26	*	*	*	*	*	*	*
332/X4295	Stump Grinder - 30" Wheel Diameter / HIGH FLOW	SG30HF	*	*	*	*	*	*	*

Table 23. Tree Spades

Part #	Item	JCB Model Name	260	280	300	330	260T	300T	320T
332/X4296	Tree Spade with Blades / 25 degree cutting angle / 18" - 26" ball diameter	TS26					*	*	*



Section A - Attachments Optional Attachments

Attachments For Your Machine

Part #	Item	JCB Model Name	260	280	300	330	260T	300T	320T
332/X4297	Tree Spade with Blades / 25 degree cutting angle / 24" - 36" ball diameter	TS36					*	*	*
332/X4298	Tree Spade with Blades / 25 degree cutting angle / 32" - 44" ball diameter	TS44					*	*	*

Table 24. COLD PLANERS

Part #	Item	JCB Model Name	260	280	300	330	260T	300T	320T
332/X4382	12" Cold Planer - Hyd. Side Shift / Tilt / Depth - Standard Flow	CP12	*	*	*	*	*	*	*
332/X4299	16" Cold Planer - Hyd. Side Shift / Tilt / Depth - HIGH FLOW	CP16HF	*	*	*	*	*	*	*
332/X4300	18" Cold Planer - Hyd. Side Shift / Tilt / Depth - HIGH FLOW	CP18HF	*	*	*	*	*	*	*
332/X4341	24" Cold Planer - Hyd. Side Shift / Tilt / Depth - HIGH FLOW	CP24HF	*	*	*	*	*	*	*
332/X4301	30" Cold Planer - Hyd. Side Shift / Tilt / Depth - HIGH FLOW	CP30HF		*	*	*		*	*
332/X4302	40" Cold Planer - Hyd. Side Shift / Tilt / Depth - HIGH FLOW	CP40HF				*			*

Table 25. Wheel Saw

Part #	Item	JCB Model Name	260	280	300	330	260T	300T	320T
332/X4345	Rock Saw - 18" Depth - HIGH FLOW	RS18HF	*	*	*	*	*	*	*
332/X4346	Rock Saw - 24" Depth - HIGH FLOW	RS24HF			*	*		*	*

Table 26. Snow Removal Attachments Blade Type - Steel or Soft

Part #	Item	JCB Model Name	260	280	300	330	260T	300T	320T
332/X4347	72" Snow Blade - Manual Angle	SBM72	*	*					
332/X4348	84" Snow Blade - Manual Angle	SBM84	*	*					
332/X4349	96" Snow Blade - Manual Angle	SBM96	*	*					
332/X4350	72" Snow Blade - Hydraulic Angle	SBH72	*	*					
332/X4351	84" Snow Blade - Hydraulic Angle	SBH84	*	*					
332/X4352	96" Snow Blade - Hydraulic Angle	SBH96	*	*					
332/L3915	96" Heavy Duty Snow Blade - Hydraulic Angle	HSB96	*	*	*	*	*	*	*
332/L3927	108" Heavy Duty Snow Blade - Hydraulic Angle	HSB108			*	*	*	*	*



Section A - Attachments Optional Attachments

Attachments For Your Machine

Part #	Item	JCB Model Name	260	280	300	330	260T	300T	320T
332/L3932	120" Heavy Duty Snow Blade - Hydraulic Angle	HSB120			*	*		*	*
332/X4383	72" Snow Blower - Standard Flow	SBL72	*	*	*				
332/X4384	78" Snow Blower - Standard Flow	SBL78	*	*	*	*	*	*	*
332/X4385	84" Snow Blower - Standard Flow	SBL84	*	*	*	*	*	*	*
332/X4399	72" Snow Blower - HIGH FLOW	SBL72HF	*	*	*				
332/X4400	78" Snow Blower - HIGH FLOW	SBL78HF	*	*	*	*	*	*	*
332/X4401	84" Snow Blower - HIGH FLOW	SBL84HF	*	*	*	*	*	*	*

Impact Protection

WARNING

When using an attachment for example a hydraulic breaker, where the risk of flying debris is present, a protective layer or screen guard must be attached to the front of the cab to protect the operator from flying debris which could cause injury.

8-5-1-5

The label **A** states that the machine is not fitted with glass protection.

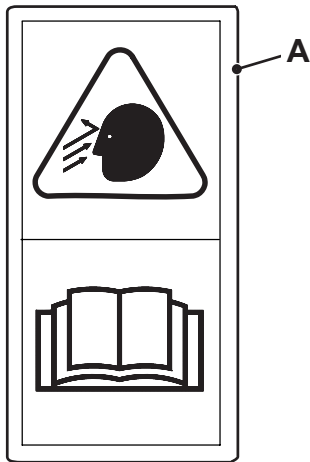

Fig 1.

332/V3761

Connecting/Disconnecting Hydraulic Hoses

T4-004

Introduction

WARNING

Fluid Under Pressure

Fine jets of fluid at high pressure can penetrate the skin. Keep face and hands well clear of fluid under pressure and wear protective glasses and gloves. Hold a piece of cardboard close to suspected leaks and then inspect the cardboard for signs of fluid. If fluid penetrates your skin, get medical help immediately.

INT-3-1-10_3

WARNING

Hydraulic Pressure

Hydraulic fluid at system pressure can injure you. Before connecting or removing any hydraulic hose, residual hydraulic pressure trapped in the service hose line must be vented. Make sure the hose service line has been vented before connecting or removing hoses. Make sure the engine cannot be started while the hoses are open.

INT-3-1-11_2

Some attachments are hydraulically powered. The following procedures show how to connect and disconnect the hydraulic hoses safely.

Connecting the Hydraulic Hoses

- 1 Make the machine safe. Refer to *Routine Maintenance, Prepare the Machine for Maintenance*.
- 2 Vent the hydraulic system. Refer to *Routine Maintenance, Releasing the Hydraulic Pressure*.
- 3 If necessary, remove the blanking caps.
- 4 Check the hoses and adaptors for damage. Refer to *Routine Maintenance, Checking for Damage*.
- 5 Connect the hoses.

If the hoses have quick releases couplings, refer to *Quick Release Couplings*.

- a Make sure that the hose is not twisted. Pressure applied to a twisted hose can cause the hose to fail or the connections to loosen.

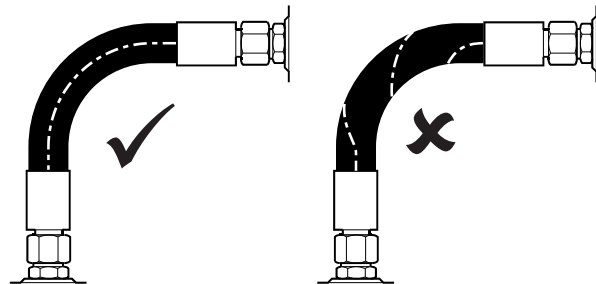

Fig 2.

T037400

- b Make sure that the hose does not touch hot parts. High ambient temperatures can cause the hose to fail.
- c Make sure that the hose does not touch parts which can rub or cause abrasion.
- d Use the hose clamps (where possible) to support long hose runs and keep the hoses away from moving parts, etc.

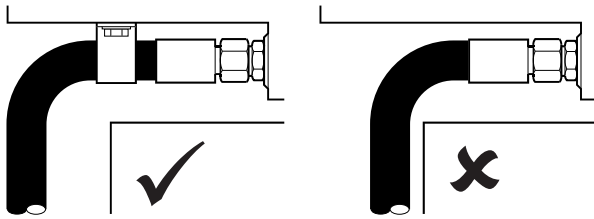

Fig 3.

T037420

To allow for length changes when the hose is pressurised, do not clamp at the bend. The curve absorbs the change.

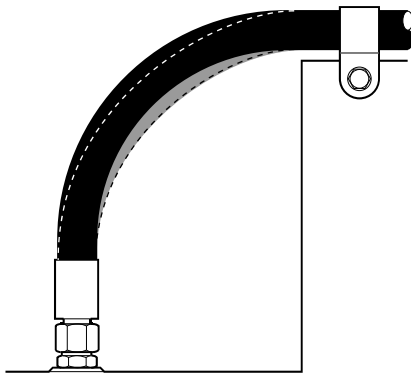

Fig 4.

T037410

Disconnecting the Hydraulic Hoses

- 1 Make the machine safe. Refer to **Routine Maintenance, Prepare the Machine for Maintenance.**
- 2 Vent the hydraulic system. Refer to **Routine Maintenance, Releasing the Hydraulic Pressure.**
- 3 Disconnect the hoses.

If the hoses have quick releases couplings, then refer to **Quick Release Couplings.**

- 4 Check the hoses and adaptors for damage. Refer to **Routine Maintenance, Checking for Damage.**
- 5 If necessary, install the blanking caps
- 6 Check for leaks.

- a Start the engine.
- b Operate the related control to increase the pressure in the hydraulic system.
- c Stop the engine then remove the starter key.
- d Check for indications of leakage at the hose connections. Correct, as necessary.

- 6 Check for leaks.
 - a Start the engine.
 - b Operate the related control to increase the pressure in the hydraulic system.
 - c Stop the engine then remove the starter key.
 - d Check for indications of leakage at the hose connections. Correct, as necessary.

Quick Release Couplings

Flat face quick release couplings allow the operator to remove and install attachments swiftly and efficiently. Generally, your machine pipework will be fitted with a female coupling **A** and a male coupling **B**. The optional attachment hoses will also be fitted with a female coupling **A** and a male coupling **B**. → [Fig 5. \(□A-15\)](#).

The quick release couplings should be trouble free and relatively easy to connect and disconnect, provided they are kept clean and used correctly. The recommendations listed below should always apply when using flat face quick release couplings.

Finally, please read the correct fitting and releasing procedures before you install or remove any optional attachment fitted with quick release couplings.

Quick Release Couplings - Do's and Don'ts

- Do wipe the two faces of the coupling and make sure they are clean before connecting.
- Do make sure the outside sleeve (female coupling) is pulled back when disconnecting.
- Do connect and disconnect a new coupling two or three times to 'work' the PTFE seals - sometimes a new coupling will stick if the seals have not been 'worked'.
- Do use a spanner on the hexagon flats of the coupling when fitting adaptors.
- Do use a rubber or hide hammer to disconnect a coupling if it sticks - sticking may occur if there is dirt present in the coupling.
- Don't attempt to re-connect a damaged half coupling - this will destroy the seals and necessitate replacing both half couplings.
- Don't leave the coupling where it may be run over by a machine or otherwise crushed - this will distort the coupling sleeve and prevent correct connection and disconnection.
- Don't clamp on the smooth diameter of the coupling when fitting adaptors - always use the hexagon.
- Don't try to turn the sleeve (female coupling) when the coupling has been disconnected - the locking ball will

wedge underneath the sleeve and destroy the coupling.

- Don't damage the faces of the couplings - this can prevent connection and disconnection, or damage seals and cause leakage.
- Don't try to dismantle the couplings - they are non serviceable parts. If a coupling is damaged it should be replaced with a new one.

WARNING

The external surfaces of the couplings must be clean before connecting or disconnecting. Ingress of dirt will cause fluid leaks and difficulty in connecting or disconnecting. You could be killed or seriously injured by faulty Quick Release Couplings.

2-4-1-15

Before connecting or removing any hydraulic hose, residual hydraulic pressure trapped in the service hose line must be vented. Make sure the hose service line has been vented before connecting or removing hoses.

Connecting Quick Release Couplings

- 1 Remove any residual hydraulic pressure trapped in the service line hose.
- 2 Wipe the two faces of the male and female couplings and make sure they are clean.
- 3 Make sure that ball **C** in the female coupling is located in one of its slots.
- 4 Fit the male coupling into the female coupling.
- 5 Where applicable, rotate sleeve **E** half a turn and make sure that the locking ball **C** does not align with the slot **D**.

Disconnecting Quick Release Couplings

- 1 Remove any residual hydraulic pressure trapped in the service line hose.
- 2 Where applicable, align the slot **D** with ball **C**.
- 3 Pull back sleeve **E** to release the coupling.

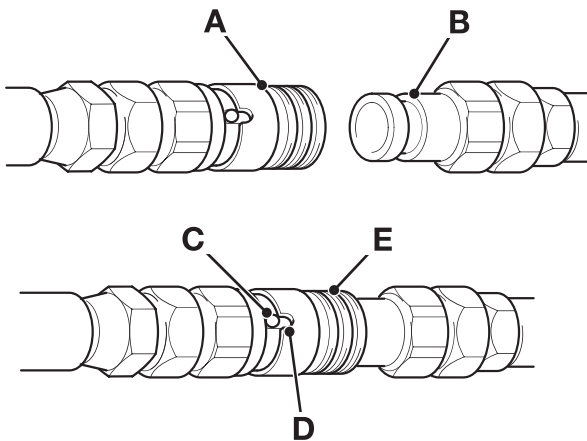

Fig 5.

C007100-1

Auxiliary Operation

Normal Operation

The auxiliary hoses are located on top of the boom.

To Engage Auxiliary Flow

- 1 Press the AUX enable switch on the right hand switch panel. The LED illuminates. [⇒ Right Hand Switch Panel \(□ 1-49\)](#).

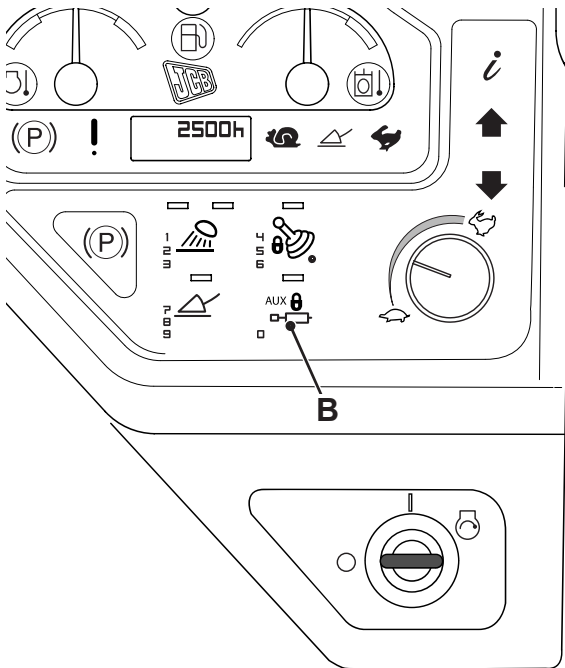

Fig 6.

T057960

- 2 Refer to the instructions supplied with the attachment before operating the attachment.

Depending on the joystick option fitted to the machine, the left or right joystick is used control the attachment functions. [⇒ Left Lever \(□ 1-43\)](#). [⇒ Right Lever \(□ 1-47\)](#).

To Disengage Auxiliary Flow

- 1 The auxiliary flow circuit can be turned OFF by pressing the Aux enable switch **B** on the right hand panel.

High Flow Operation

Some attachments require a high flow of hydraulic oil to functions correctly. High flow must be engaged for this type of attachment. Refer to the instructions supplied with the attachment to determine if the attachment requires high flow.

To Engage High Flow

- 1 Ensure that the AUX enable switch **B** is off. The LED is ON. [⇒ Right Hand Switch Panel \(□ 1-49\)](#).
- 2 Press the high flow switch **A** on the left hand switch panel and ensure the LED is ON. [⇒ Fig 6. \(□ A-16\)](#). [⇒ Left Hand Switch Panel \(□ 1-45\)](#)

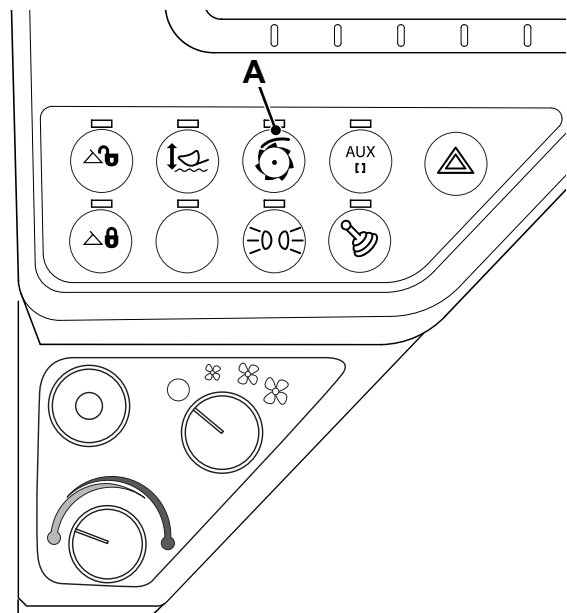

Fig 7.

T057960



- 3 Once the High Flow LED is ON then press the Aux enable switch **B** on the right hand panel. ⇒ [Right Hand Switch Panel \(□ 1-49\)](#).
- 4 High flow is now available for the attachment.

To Disengage High Flow

- 1 The high flow circuit can be turned OFF by pressing the high flow switch **A** on the left hand panel or pressing the Aux enable switch **B** on the right hand panel.

Hydraulic Quick Hitch Control

To Release the Attachment

- 1 Rest attachment on the ground.
- 2 Press and hold the unlock switch **A** located in the left hand panel.
- 3 Verify visually that the cylinder is fully extended.
- 4 If appropriate disconnect the attachment hydraulic hoses loader arm pipework. .
- 5 Lower the loader arm fully to bring the hitch plate **C** below the level of the lips on the shovel/attachment. .
- 6 Operate the loader control lever as if to roll forward the shovel/attachment .When the hitch plate **C** has disengaged from the lips on the shovel/attachment, reverse the machine clear.

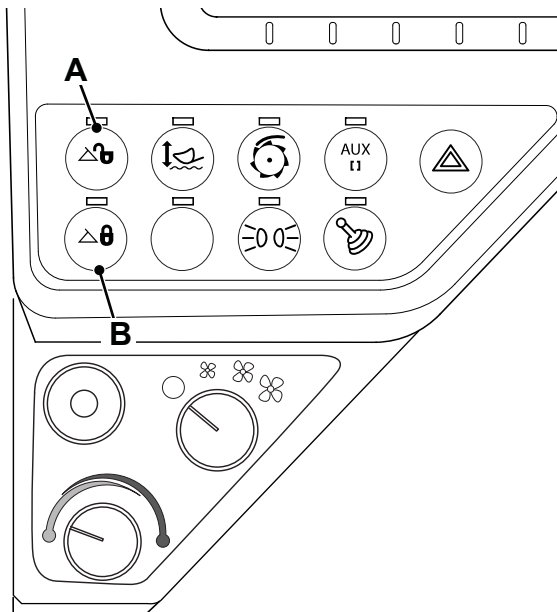

Fig 8.

T057970

To Engage the Attachment

- 1 Align the machine square to the shovel/attachment.

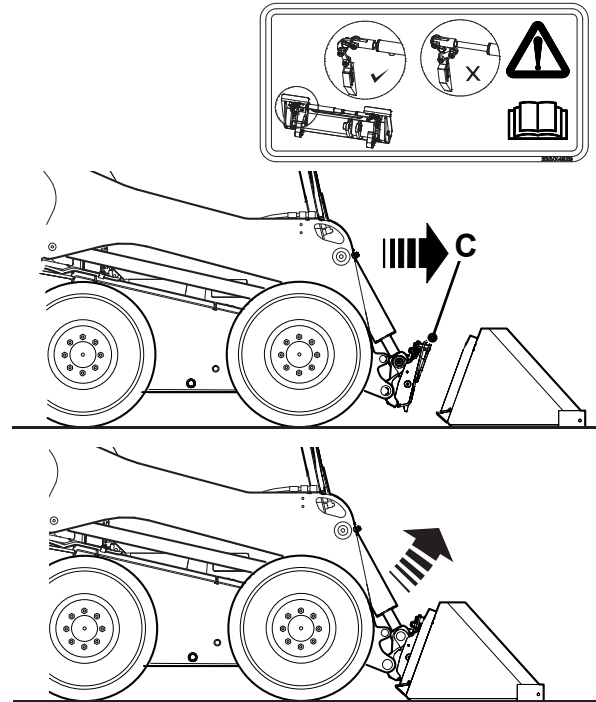

Fig 9.

T057980

- 2 Lower the loader arm fully to bring the hitch plate **C** below the level of the lips on the shovel/attachment.
- 3 Drive the machine slowly forward. Stop when the hitch plate **C** just touches the shovel/attachment.
- 4 Visually verify that the quickhitch hydraulic cylinder is fully extended prior to engaging the hitch plate **C** into the attachment
- 5 Raise the loader arm and engage the hitch plate **C** in the lips on the shovel/attachment. Stop the movement as soon as the plate is engaged.
- 6 Move the loader control lever to roll back the shovel/ attachment slightly.

- 7 Once hitch plate **C** is engaged depress and hold the lock switch **B**.
- 8 Ensure the hydraulic cylinder is fully retracted and visually inspect that locking pins are engaged into the attachment.

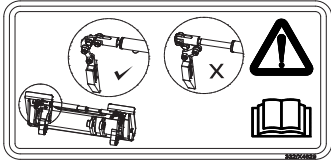

Fig 10.

T057980-1

Manual Quickhitch Control

Engaging the Shovel/Attachments

To engage a shovel or other attachment on the Quickhitch, do the following:

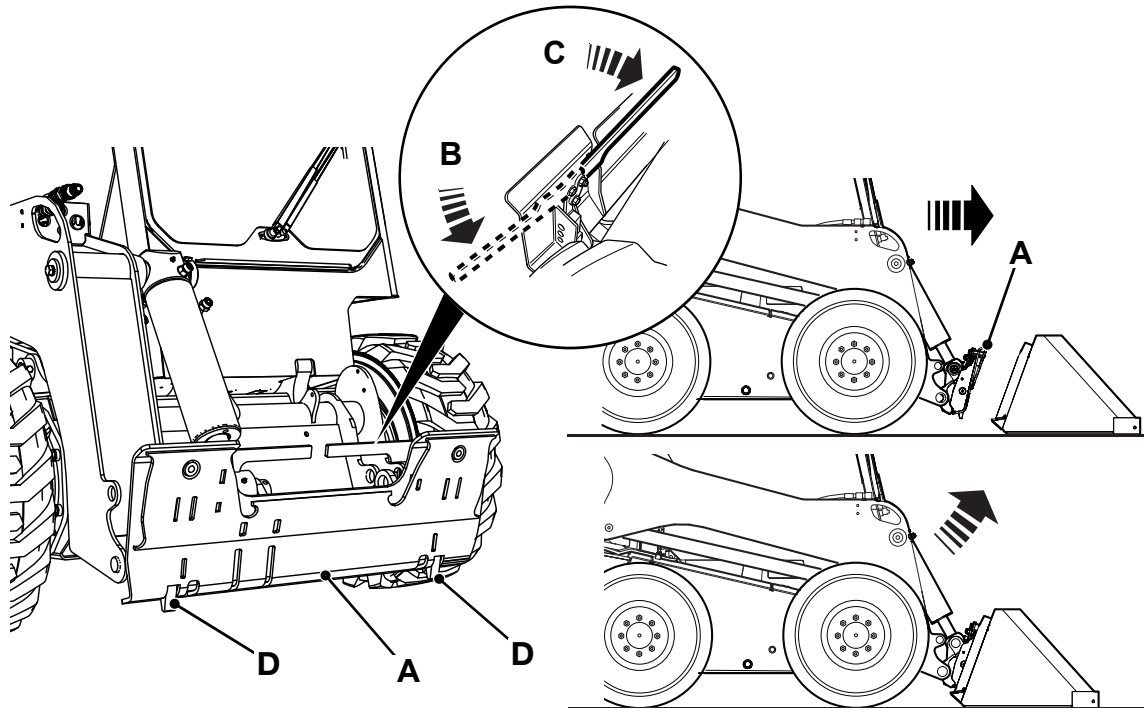

Fig 11.

WARNING

Do not lean out of the cab to operate the Quickhitch levers. If the controls are moved accidentally you could be killed or injured.

3-4-1-8

- 1 Align the machine square to the shovel/attachment.
- 2 Lower the loader arm fully to bring the hitch plate **A** below the level of the lips on the shovel/attachment. Move levers (one each side of hitch plate) fully out as at position **B**.
- 3 Drive the machine slowly forward. Stop when the hitch plate **A** just touches the shovel/attachment.
- 4 Raise the loader arm and engage the hitch plate **A** in the lips on the shovel/attachment. Stop the movement as soon as the plate is engaged.
- 5 Move the Loader Control Lever to roll back the shovel/attachment slightly.
- 6 Stop the engine and remove the ignition key.
If the keyless ignition option is fitted stop the engine and wait 15 seconds.
- 7 Raise the safety control locks and dismount the machine.



Section A - Attachments Optional Attachments

Manual Quickhitch Control

- 8 Push levers fully in, as at position **C**, to engage Quickhitch locking pins **D**. Check that the levers locked into the detents.
- 9 Check that the pins are engaged through the attachment.
- 10 The shovel/attachment is now locked onto Quickhitch.
- 11 If appropriate connect the attachment tail hoses loader arm pipework. → [Connecting/Disconnecting Hydraulic Hoses \(A-12\)](#). → [Releasing the Auxiliary Hydraulic Pressure \(1-158\)](#).
- 12 Return to the cab seat and lower the safety control locks. The shovel/attachment is now ready for use.

Disengaging the Shovel/Attachments

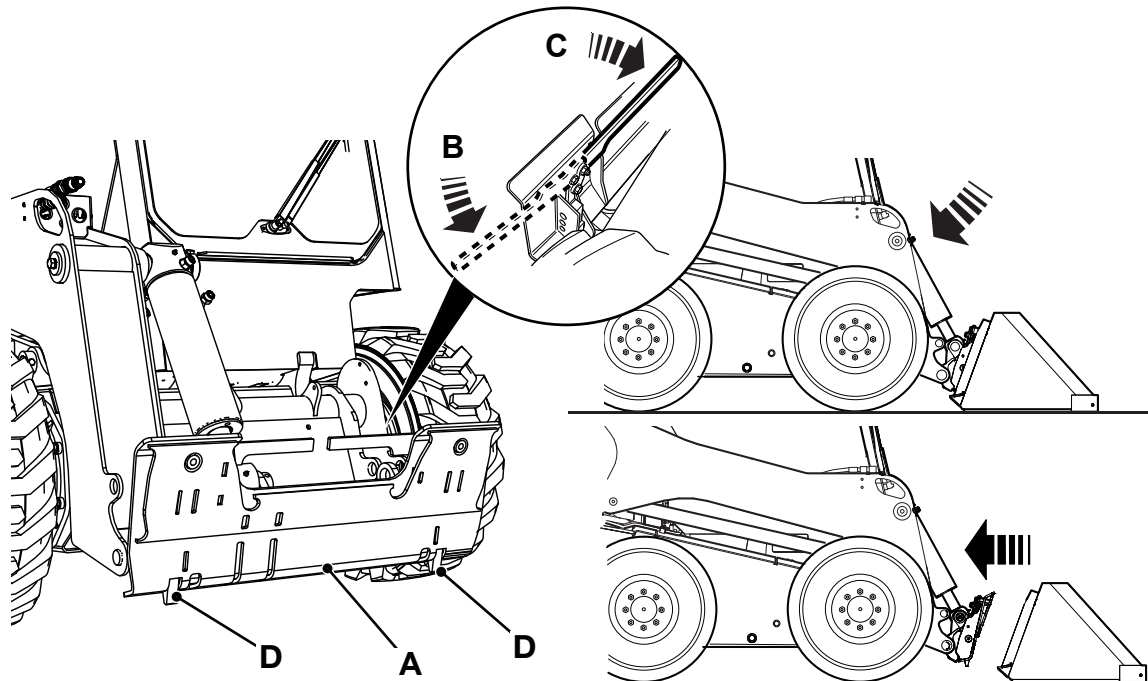

Fig 12.

- 1 Stop and park the machine on level ground.
- 2 Lower the shovel/attachment to the ground.
- 3 Stop the engine and relieve hydraulic circuit pressure. [⇒ Releasing the Auxiliary Hydraulic Pressure \(□ 1-158\).](#)
- 4 Raise the safety control locks and dismount from the machine.
- 5 If appropriate disconnect the attachment hydraulic hoses loader arm pipework. [⇒ Connecting/ Disconnecting Hydraulic Hoses \(□ A-12\).](#)
- 6 Pull levers (one each side of hitch plate) fully out, as at position **B**, to retract the Quickhitch locking pins **D**.
- 7 Return to the cab seat, lower the Safety Restraint Bar and start the engine.
- 8 Operate the loader Control Lever as if to roll forward the shovel/attachment [⇒ Drive Controls, Switches and Instruments \(□ 1-40\)](#). When the hitch plate **A** has disengaged from the lips on the shovel/attachment, reverse the machine clear.
- 9 Push levers fully in, as at position **C**.

DANGER

Do not retract the locking pins when the loader arm is raised, the shovel could fall and kill or seriously injure someone. Retract the locking pins only after the shovel has been placed on the ground.

4-2-2-1_1

WARNING

Do not lean out of the cab to operate the Quickhitch levers. If the controls are moved accidentally you could be killed or injured.

3-4-1-8

- 5 If appropriate disconnect the attachment hydraulic hoses loader arm pipework. [⇒ Connecting/ Disconnecting Hydraulic Hoses \(□ A-12\).](#)
- 6 Pull levers (one each side of hitch plate) fully out, as at position **B**, to retract the Quickhitch locking pins **D**.

Attachment Frame

Some attachments, e.g. hammers and earth drills, utilise an attachment frame for installing on a Skid Steer Loader.

Installation and Removal

Installation

- 1 Stand the attachment frame on level ground as shown at **A**. Drive the Skid Steer Loader squarely up to the frame and stop.

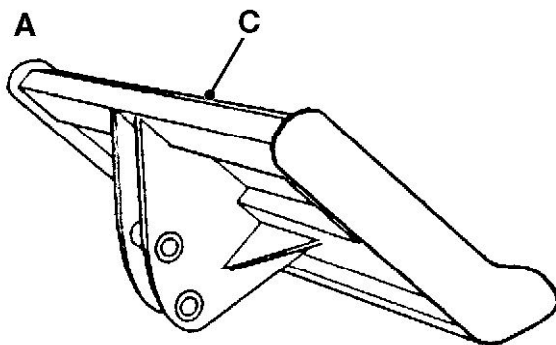

Fig 13.

- 2 Lower the loader arm and tilt forward Quickhitch plate **B** so that the top of the plate is lower than the lip **C** of the attachment frame. Move Quickhitch levers (one each side of hitch plate) fully out, as at position **D**.

WARNING

Do not lean out of the cab to operate the Quickhitch levers. If the controls are moved accidentally you could be killed or injured.

3-4-1-8

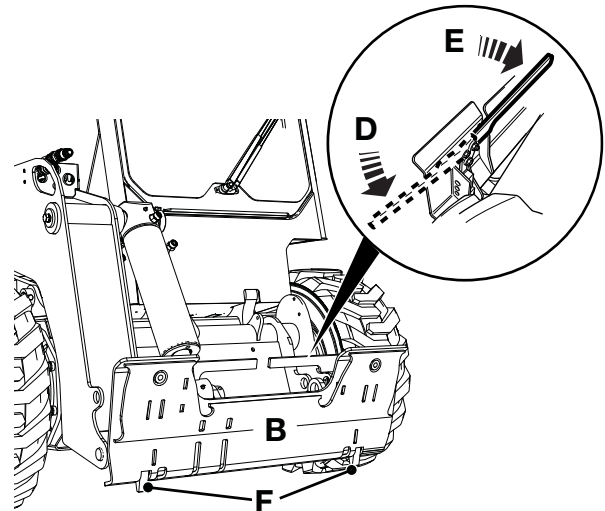

Fig 14.

- 3 Drive the machine forward until the Quickhitch plate touches the attachment frame then stop.
- 4 Slowly tilt the plate backwards until it engages the attachment frame lip. Raise the loader arm until the frame is in contact with the Quickhitch plate, top and bottom.
- 5 Push Quickhitch levers fully in, as at position **E**, to engage locking pins **F** and secure the attachment frame.
- 6 Refer to the Owners Manual of the particular attachment for full instructions concerning its installation/removal from the attachment frame.

Removal

- 1 Removal is the reversal of steps 1 to 5 above.

Shovels

Most attachments have an integral framework, such as the one shown below, to make them Quickhitch compatible. Others such as the Earth drill, Hammer and compactor require a separate frame. → [Attachment Frame \(A-23\)](#). Consult the relevant attachment literature or your JCB Distributor as to the framework required.

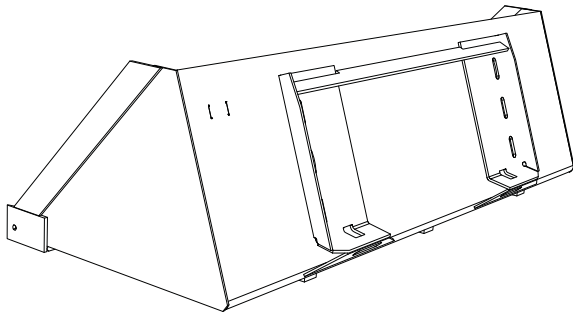

T057380

Fig 15. Typical Quickhitch Attachment Framework

6-in-1 Shovel

The 6-in-1 shovel allows you to load, dig, grab, grade, doze and spread without changing attachments.

It is similar to a normal shovel except that it has an opening clam which is operated by hydraulic rams mounted on the bucket frame.

Operation

Always operate the controls slowly and carefully. Drive slowly and carefully when the bucket is loaded. Keep the shovel low to the ground when moving, this increases your visibility and makes the machine more stable.

Control

The lift, lower, open and close movements of the 6-in-1 shovel are controlled by the loader control lever(s) → [Operating Levers and Pedals \(1-62\)](#).

The shovel clam is operated either by a foot pedal or by the right hand control lever. → [Operating Levers and Pedals \(1-62\)](#).

1/2 Loading and Digging

With the clam closed, the shovel can be used as a conventional shovel. → [Working With The Loader \(1-83\)](#). For higher dumping, open the clam instead of rolling the shovel.

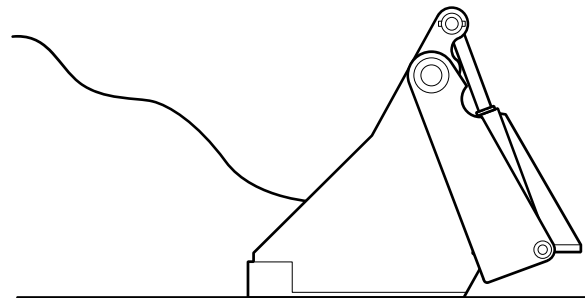

Fig 16.

3 Grabbing

Open the clam and set the shovel directly above the object to be grabbed. To grab the object, lower the shovel and close the clam.

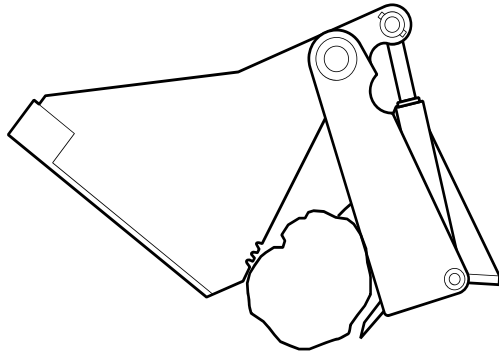

Fig 17.

4 Grading

To grade, open the clam and drag the shovel backwards. When the shovel is full, roll it back and close the clam.

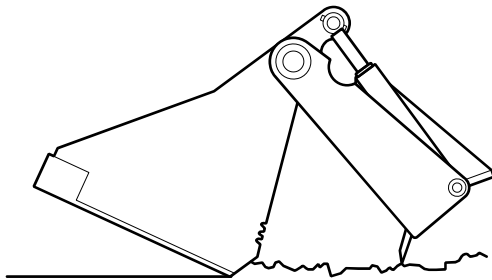

Fig 18.

5 Dozing

To doze, open the clam and drive the machine forward.

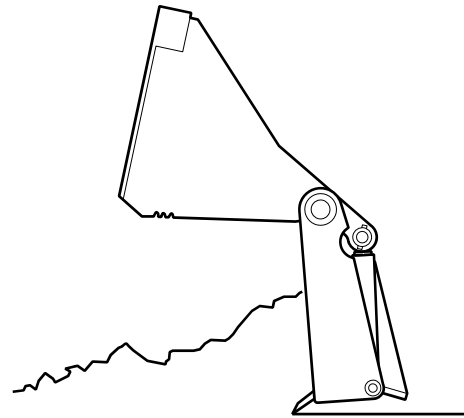

Fig 19.

6 Spreading

Load the shovel with the material to be spread. Set the clam opening to suit the size of material and rate of flow. Drag the shovel backwards, allowing it to discharge an even layer of material as it goes.

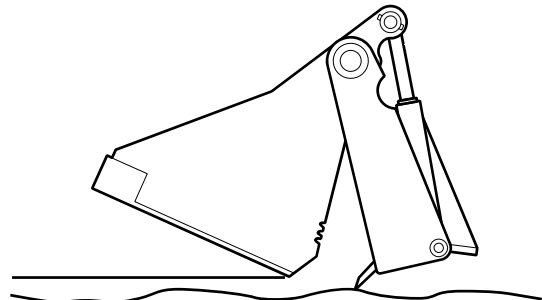

Fig 20.

Install the 6-in-1 Bucket

Important: To avoid serious personal injury, make sure the bucket is securely latched to the attachment mechanism of your unit. Failure to do so could result in separation of the bucket from the unit.

- 1 Connect the hydraulic quick couplers to the auxiliary hydraulics and route the hoses in such a fashion as to prevent chafing and pinching.
- 2 Start engine and slowly cycle the bucket cylinders several times to purge system of air, and check for proper hydraulic connection, hose routing, and hose length.

- 3 Check the attachment for proper assembly, installation, and hydraulic leaks.

Detach the 6-in-1 Bucket

- 1 On firm level ground, close the clam and lower the loader arm completely down on the frame until the bucket is level and approximately 2" off the ground.
- 2 Turn off the engine.
- 3 Release the hydraulic pressure. → [Releasing the Auxiliary Hydraulic Pressure \(□ 1-158\)](#).
- 4 Disconnect the couplers.

Note: Connect couplers together or install caps to prevent contaminants from entering the hydraulic system.

- 5 Lower the bucket to the ground.
- 6 Detach the bucket.

Note: Frequent lubrication of grease fittings at the end of the cylinders and pivot points with a multi-purpose grease will greatly increase life of the product.

Preparing for Travel

Close the clam then treat as a standard shovel.

Maintenance

→ [Service Schedules \(□ 1-101\)](#).

Grease Points

There are 4 grease points. (1 and 2 as illustrated, 3 and 4 at opposite end.).

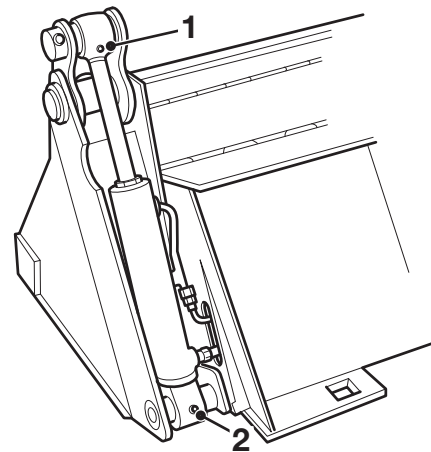

Fig 21.

Storage

- 1 Clean the unit thoroughly, removing all mud, dirt, and grease.
- 2 Inspect for visible signs of wear, breakage, or damage. Order any parts required and make the necessary repairs to avoid delays when starting next season.
- 3 Tighten loose nuts, capscrews, and hydraulic connections.
- 4 Cap hydraulic couplers to protect against contaminants.
- 5 Touch up all un-painted surfaces with paint, to prevent rust.
- 6 Coat the exposed portions of the cylinder rods with grease.
- 7 Store the unit in a dry and protected place. Leaving the unit outside will shorten its life.

Grapple Bucket

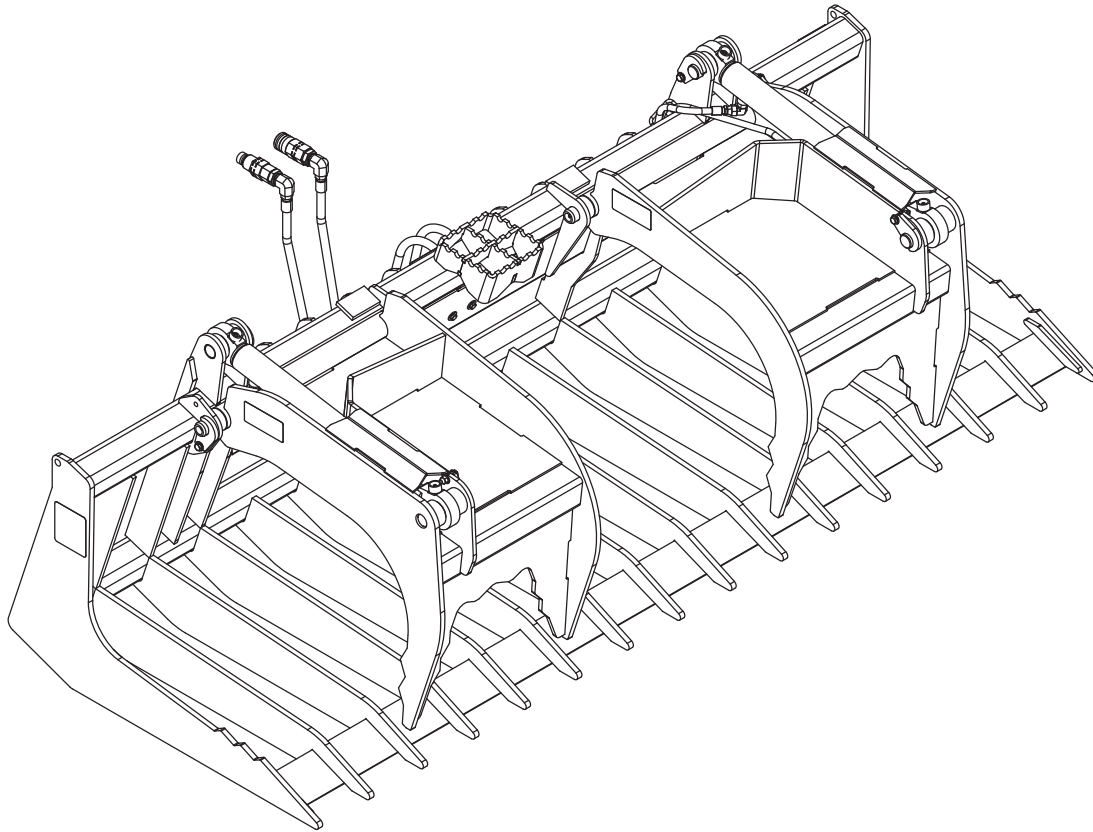

Fig 22.

T055090

Installation and Removal

⇒ [Hydraulic Quick Hitch Control \(□A-18\)](#). ⇒ [Manual Quickhitch Control \(□A-20\)](#).

Operation

Important: The grapple moves quickly. Do not allow anyone near the grapples.

Important: Never get between the grapple and the bucket.

Important: Do not lift any load that is taller than the height of the fully opened grapple.

Important: Do not roll back this product so far that the load falls off toward or on the operator.

Positioning the Load

Approach the load so that the weight will be centred on the floor of the attachment.

If the load has a heavy side, then that side should be closest to the rear of the bucket rather than near the bucket edge.

If the grapple is ever used as a rake to drag materials into a position for being picked up, the grapple must be completely opened. Applying a raking-type force to the partially opened grapple will greatly magnify the fluid pressure in the hydraulic hoses, fittings, and cylinders and may cause those components to fail.

Note: Using the partially opened grapple as a rake can result in damage to this product and will void any warranty



Make certain that the bucket is completely under the load and make certain that the bucket floor is level.

Roll back (crowd) the grapple to the fullest extent possible.

Lift the load slightly and make sure that the load is secure. If the load appears to be unstable, lower the load, reposition the load to achieve full stability, and repeat above steps until full stability is achieved.

Transporting the Load

- Raise the load to the minimum height required for the terrain that must be crossed with the load.
- Operate the machine so that the load always remains level.
- Accelerate, turn, and brake gradually.
- Avoid any obstacles, bumps, or holes in your intended path.
- Frequently check the load to make sure that the load has not become unstable.

Maintenance

⇒ [Service Schedules \(□ 1-101\)](#).

Storage

- 1 Clean the unit thoroughly, removing all mud, dirt, and grease.
- 2 Inspect for visible signs of wear, breakage, or damage. Order any parts required, and make the necessary repairs to avoid delays when starting next season.
- 3 Tighten loose nuts, capscrews, and hydraulic connections.
- 4 Cap hydraulic couplers to protect against contaminants.
- 5 Touch up all un-painted surfaces with paint, to prevent rust.
- 6 Coat the exposed portions of the cylinder rod with grease.
- 7 Store the unit in a dry and protected place. Leaving the unit outside will materially shorten its life.

Pallet Forks

The pallet fork frame includes a Rating Plate which gives its weight and its Safe Working Load.

The forks should always be used in pairs as supplied. Each fork is stamped with its Part Number and Safe Working Load.

- 2 Lift the forks off of their rail and move them left or right to the required positions.
- 3 When the forks are in the required position lower the forks down onto their rail. Make sure the forks lock into position in the slots.

CAUTION

Fork Spacing

Loads can fall off incorrectly spaced forks. Always space the forks correctly for the load. Make sure the forks are completely under the load before lifting.

5-1-4-2

Installation and Removal

⇒ [Hydraulic Quick Hitch Control \(□ A-18\)](#). ⇒ [Manual Quickhitch Control \(□ A-20\)](#).

Operation

Control

The forks are operated by the loader control lever ⇒ [Loader Controls \(□ 1-62\)](#)

Operate the control carefully when using the forks.

Road Travel

WARNING

The Quick-Hitch forks must not be fitted for road travel. Failure to comply may render the operator vulnerable to criminal prosecution. If the machine has to travel on public roads the forks must be removed.

2-4-5-4

Maintenance

⇒ [Service Schedules \(□ 1-101\)](#)

Adjust the Fork Spacing

- 1 Position the forks until they are just clear of the ground.

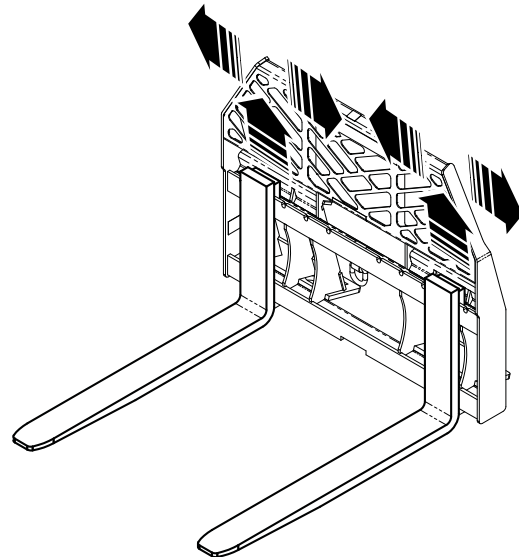

Fig 23.

Manure/Silage Fork with Top Grab

The Manure/Silage fork is fitted with a top grab as standard which gives extra security to the pay load when moving the machine.

The grab is open and closed by a hydraulic ram mounted on the fork frame.

Installation and Removal

⇒ [Hydraulic Quick Hitch Control \(□A-18\)](#). ⇒ [Manual Quickhitch Control \(□A-20\)](#).

Operation

Always operate the controls slowly and carefully. Drive slowly and carefully when the Manure/Silage fork is loaded. Keep the fork low to the ground when moving, this increases your visibility and makes the machine more stable.

Open the top grab before loading the fork. Close the top grab on the load before moving the machine.

To unload the fork, raise it to a suitable height, open the top grab and tilt down.

Control

The lift, lower and tilt movements of the fork are controlled by the loader control lever ⇒ [Loader Controls \(□ 1-62\)](#).

Depending on the joystick option fitted to the machine, the left or right joystick is used control the attachment functions . ⇒ [Left Lever \(□ 1-43\)](#). ⇒ [Right Lever \(□ 1-47\)](#).

Preparing for Travel

Close the grab; then treat as a standard shovel.

Maintenance

Grease Points

There are 5 grease points.

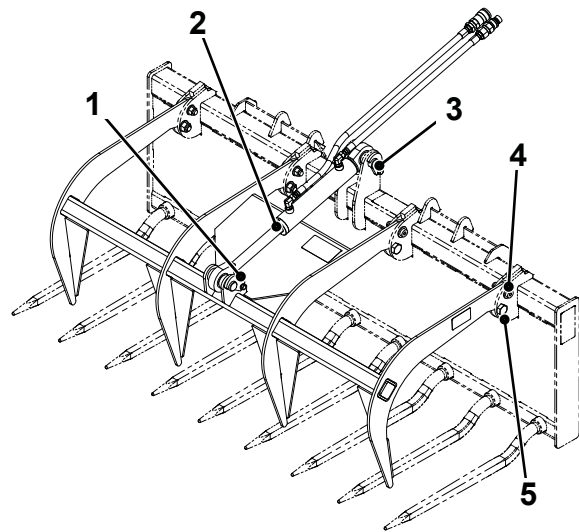

Fig 24.

Snow Blade

Installation and Removal

⇒ [Hydraulic Quick Hitch Control \(□A-18\)](#). ⇒ [Manual Quickhitch Control \(□A-20\)](#).

Installation of Optional Rubber Edge

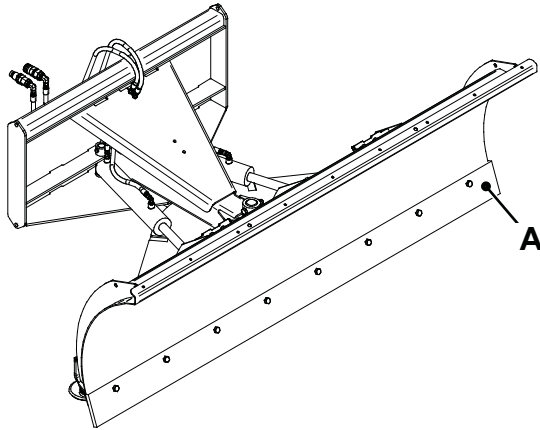

Fig 25.

- 1 Remove the standard wear edge **A** and set aside the wear edge and all bolts. ⇒ [Replacement of Wear Edge \(□A-34\)](#).

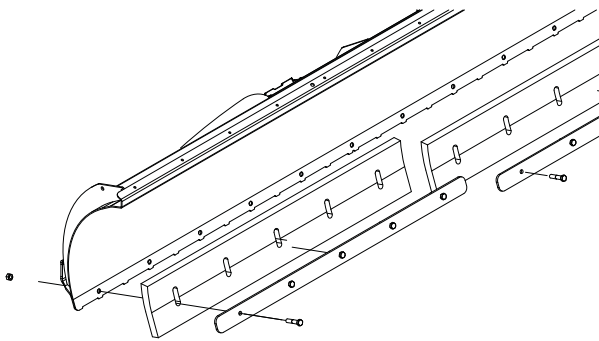

Fig 26.

- 2 Insert the bolts provided with the rubber edge through the steel strip, the rubber edge, and the base of the moldboard. ⇒ [Fig 26. \(□A-31\)](#). Loosely secure the

bolts with the lock washers and nuts that were removed in step 1.

Position the rubber edge so that no more than 1" of the edge extends below the lowest point of the moldboard and tighten the nuts to 102 Nm (75 lbs/ft).

Position the rubber edge so that no more than 1.5" of the edge extends below the lowest point of the moldboard and tighten the nuts to 203 Nm (150 lbs/ft).

Operation

Before any snowfall, inspect the site where the snow blade is to be used. Locate any obstructions (i.e. curbs, sidewalks, parking bumpers, pipes, shrubs, fences, etc.) and any variations in elevation (i.e. retaining walls, slopes, holes, etc.) so that these elements can be avoided during the snow plowing operation.

Important: Dozing of undisturbed soil, heavy materials, or similar items can result in damage to the snow blade.

Maintenance

⇒ [Service Schedules \(□ 1-101\)](#).

Grease Points

There is 1 grease point **A**.

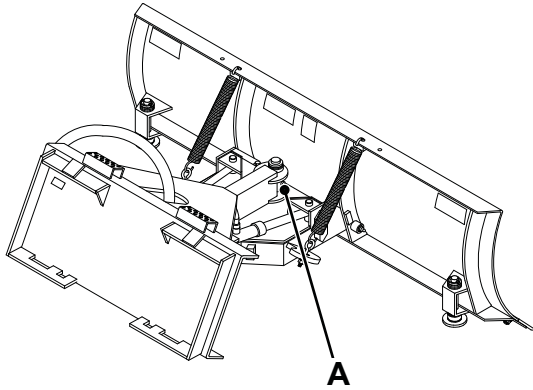

Fig 27.

Spring Setup

- 1 Park the machine on a level surface with the snow blade properly attached. ⇒ [Installation and Removal \(□ A-31\)](#).
- 2 Engage the park brake.
- 3 Lower the snow blade onto the level surface.
- 4 Turn off the engine, remove the ignition key.

If the keyless ignition option is fitted stop the engine and wait 15 seconds.

- 5 Relieve all pressure in the hydraulic lines. ⇒ [Releasing the Auxiliary Hydraulic Pressure \(□ 1-158\)](#).
- 6 Make sure that the springs on the snow blade comply with the specifications listed in the appropriate tables below.

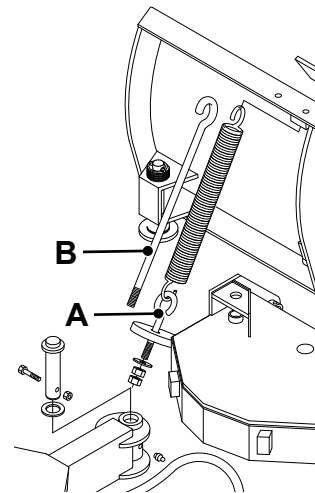

Fig 28.

If necessary tighten or slacken the eye bolts **A** to change the length of the springs.

Note: The spring setup lengths are measured from the inside of one hook to the inside of the other hook. The relaxed length of a spring is 14"

- 7 Test the snow blade. If the moldboard trips too easily, perform the following steps as needed:
 - a Repeat the preceding steps (1 through 5).
 - b Tighten the spade (or eye) bolts to lengthen the springs.
 - c Test operate the snow blade again. If the moldboard still trips too easily, then contact your JCB dealer.



Section A - Attachments Optional Attachments

Snow Blade

Table 27. Recommended Spring Setup Lengths - Standard

Blade Width	72	84	96
Recommended spring setup length (Max length permitted: 16.12")	15"	15"	15"

Table 28. Recommended Spring Setup Lengths - Heavy Duty

Blade Width	96	108	120
Recommended spring setup length (Max length permitted: 15.13")	14.38"	14.56"	14.75"

Important: Lengthening the springs beyond their maximum permitted length can result in damage to snowblade.



Replacement of Wear Edge

- 1 Park the machine on a level surface with the snow blade properly attached.
- 2 Engage the park brake.
- 3 Lower the snow blade onto blocking positioned immediately behind the moldboard. This blocking must be of sufficient height to hold the wear edge approximately 6" to 8" above the level surface.
- 4 Turn off the engine, remove the ignition key.

If the keyless ignition option is fitted stop the engine and wait 15 seconds.

- 5 Relieve all pressure in the hydraulic lines.
→ [Releasing the Auxiliary Hydraulic Pressure \(□ 1-158\)](#).

- 8 Repeat step 6 for the other end of the wear edge. Properly dispose of the wear edge and all bolts and nuts.

Standard Snow Blade Only:

These edges are reversible and may be flipped top-to-bottom for reinstallation.

- 9 Reinstall a new wear edge and tighten the nuts to 75 ft. lbs.

Heavy Duty Snow Blade Only:

Tighten the nuts to 150 ft. lbs.

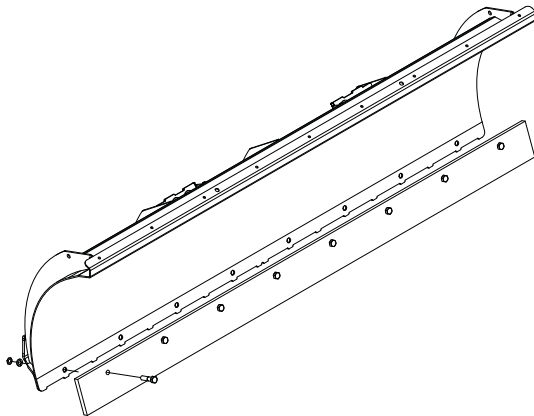

Fig 29.

- 6 Loosen the nuts on all the wear edge bolts and remove all nuts and wear edge bolts except the bolts on each end of the wear edge.
- 7 While holding up the end of the wear edge, remove the nut and bolt from that end and allow that end to pivot down to the level surface.