

Product: 2005-2006 Canon iR2020/2016 Series Printer Service Repair Workshop Manual
Full Download: <https://www.arepairmanual.com/downloads/2005-2006-canon-ir20202016-series-printer-service-repair-workshop-manual/>

Service Manual

iR2020/2016 Series

The Canon logo is displayed in a bold, black, serif font, centered at the bottom of the page.

Sample manual. Download All pages at:

<https://www.arepairmanual.com/downloads/2005-2006-canon-ir20202016-series-printer-service-repair-workshop-manual/>

Sep 14 2005

Product: 2005-2006 Canon iR2020/2016 Series Printer Service Repair Workshop Manual
Full Download: <https://www.arepairmanual.com/downloads/2005-2006-canon-ir20202016-series-printer-service-repair-workshop-manual/>

Sample manual. Download All pages at:
<https://www.arepairmanual.com/downloads/2005-2006-canon-ir20202016-series-printer-service-repair-workshop-manual/>

Application

This manual has been issued by Canon Inc. for qualified persons to learn technical theory, installation, maintenance, and repair of products. This manual covers all localities where the products are sold. For this reason, there may be information in this manual that does not apply to your locality.

Corrections

This manual may contain technical inaccuracies or typographical errors due to improvements or changes in products. When changes occur in applicable products or in the contents of this manual, Canon will release technical information as the need arises. In the event of major changes in the contents of this manual over a long or short period, Canon will issue a new edition of this manual.

The following paragraph does not apply to any countries where such provisions are inconsistent with local law.

Trademarks

The product names and company names used in this manual are the registered trademarks of the individual companies.

Copyright

This manual is copyrighted with all rights reserved. Under the copyright laws, this manual may not be copied, reproduced or translated into another language, in whole or in part, without the written consent of Canon Inc.

COPYRIGHT © 2001 CANON INC.









Printed in Japan

Caution

Use of this manual should be strictly supervised to avoid disclosure of confidential information.



Symbols Used

This documentation uses the following symbols to indicate special information:

Symbol	Description
	Indicates an item of a non-specific nature, possibly classified as Note, Caution, or Warning.
	Indicates an item requiring care to avoid electric shocks.
	Indicates an item requiring care to avoid combustion (fire).
	Indicates an item prohibiting disassembly to avoid electric shocks or problems.
	Indicates an item requiring disconnection of the power plug from the electric outlet.
 Memo	Indicates an item intended to provide notes assisting the understanding of the topic in question.
 REF.	Indicates an item of reference assisting the understanding of the topic in question.
	Provides a description of a service mode.
	Provides a description of the nature of an error indication.

The following rules apply throughout this Service Manual:

1. Each chapter contains sections explaining the purpose of specific functions and the relationship between electrical and mechanical systems with reference to the timing of operation.

In the diagrams,  represents the path of mechanical drive; where a signal name accompanies the symbol, the arrow  indicates the direction of the electric signal.

The expression "turn on the power" means flipping on the power switch, closing the front door, and closing the delivery unit door, which results in supplying the machine with power.

2. In the digital circuits, '1' is used to indicate that the voltage level of a given signal is "High", while '0' is used to indicate "Low". (The voltage value, however, differs from circuit to circuit.) In addition, the asterisk (*) as in "DRMD*" indicates that the DRMD signal goes on when '0'.

In practically all cases, the internal mechanisms of a microprocessor cannot be checked in the field. Therefore, the operations of the microprocessors used in the machines are not discussed: they are explained in terms of from sensors to the input of the DC controller PCB and from the output of the DC controller PCB to the loads.

The descriptions in this Service Manual are subject to change without notice for product improvement or other purposes, and major changes will be communicated in the form of Service Information bulletins.

All service persons are expected to have a good understanding of the contents of this Service Manual and all relevant Service Information bulletins and be able to identify and isolate faults in the machine."

Contents

Chapter 1 Introduction

1.1 System Construction	1- 1
1.1.1 Pickup/ Delivery /Original Handling Accessories System Configuration (iR2020/iR2020J)	1- 1
1.1.2 Pickup/ Delivery /Original Handling Accessories System Configuration (iR2016/iR2016J)	1- 2
1.1.3 Reader Heater/ Cassette Heater System Configuration	1- 3
1.1.4 Printing/Transmitting Accessories System Configuration (iR2020J/iR2016J)	1- 3
1.1.5 Printing/Transmitting Accessories System Configuration (iR2020/iR2016)	1- 4
1.1.6 Functions of the Printing/Transmission Functions (iR2020/iR2016)	1- 4
1.2 Product Specifications	1- 5
1.2.1 Names of Parts	1- 5
1.2.1.1 External View ÅiR2020/iR2020J)	1- 5
1.2.1.2 External View ÅiR2016/iR2016J)	1- 6
1.2.1.3 Cross-Section	1- 7
1.2.2 Using the Machine	1- 8
1.2.2.1 Turning On the Power Switch	1- 8
1.2.2.2 When Turning Off the Main Power Switch	1- 9
1.2.2.3 Control Panel	1- 10
1.2.3 User Mode Items	1- 11
1.2.3.1 Common Settings	1- 11
1.2.3.2 Copy Settings	1- 11
1.2.3.3 FAX Settings	1- 11
1.2.3.4 Address Book Set.	1- 12
1.2.3.5 Printer Settings	1- 12
1.2.3.6 Timer Settings	1- 13
1.2.3.7 Report Settings	1- 13
1.2.3.8 Adjust./Cleaning	1- 13
1.2.3.9 System Settings	1- 13
1.2.4 Maintenance by the User	1- 15
1.2.4.1 User Maintenance Items	1- 15
1.2.4.2 Cleaning	1- 15
1.2.5 Safety	1- 16
1.2.5.1 Safety of the Laser Light	1- 16
1.2.5.2 CDRH Regulations	1- 16
1.2.5.3 Handling the Laser Unit	1- 17
1.2.5.4 Safety of Toner	1- 17
1.2.5.5 Point to Note about Fire	1- 18
1.2.5.6 Cautions as to the replacement and disposal of lithium battery	1- 18
1.2.6 Product Specifications	1- 19
1.2.6.1 Product Specifications	1- 19
1.2.7 Function List	1- 20
1.2.7.1 Printing Speed (iR2020/iR2020J)	1- 20
1.2.7.2 Printing Speed (iR2016/iR2016J)	1- 21
1.2.7.3 Types of Paper	1- 21

Chapter 2 Installation

2.1 Making Pre-Checks	2- 1
2.1.1 Selecting the Site of Installation.....	2- 1
2.1.2 Before Starting the Work (230V EUR).....	2- 1
2.2 Unpacking and Installation	2- 3
2.2.1 Unpacking and Removing the Packaging Materials.....	2- 3
2.2.2 Installing the Drum Unit.....	2- 3
2.2.3 Installing the Toner Bottle.....	2- 4
2.2.4 Setting the Cassettes	2- 5
2.2.5 Attaching the Ferrite Core.....	2- 6
2.2.6 Checking the Image Quality	2- 6
2.2.7 Setting the Country/Region	2- 7
2.2.8 Setting the Date and Time.....	2- 7
2.3 Checking the Connection to the Network.....	2- 8
2.3.1 Checking the Network Connection.....	2- 8
2.4 Installing the Card Reader.....	2- 9
2.4.1 Points to Note	2- 9
2.4.2 Checking the Contents.....	2- 9
2.4.3 Installation Procedure.....	2- 10
2.4.4 Registering the Card IDs.....	2- 16
2.5 Installing the Heater PCB	2- 17
2.5.1 Unpacking and Checking the Contents	2- 17
2.5.2 Preparing the Host Machine.....	2- 17
2.5.3 Installing the Heater PCB	2- 19
2.6 Installing the Reader Heater.....	2- 22
2.6.1 Unpacking and Checking the Contents	2- 22
2.6.2 Installing the Reader Heater Harness.....	2- 22
2.6.3 Removing Reader Components	2- 26
2.6.4 Removing Parts at the Left of the Reader.....	2- 27
2.6.5 Installing the Reader Heater.....	2- 29
2.7 Installing the Cassette Heater.....	2- 32
2.7.1 Unpacking and Checking the Contents	2- 32
2.7.2 Preparing the Host Machine.....	2- 32
2.7.3 Installing the Cassette Heater.....	2- 32

Chapter 3 Main Controller

3.1 Construction.....	3- 1
3.1.1 Construction and Mechanisms.....	3- 1
3.2 Construction of the Electrical Circuitry.....	3- 1
3.2.1 Image Processor PCB.....	3- 1
3.3 Image Processing	3- 2
3.3.1 Overview of the Image Flow.....	3- 2
3.3.2 Construction of the Image Processing Module	3- 3
3.3.3 Reader Unit Input Image Processing.....	3- 3
3.3.4 Compressio/ Extesion/ Editing Block.....	3- 4
3.3.5 Compressio/ Extesion/ Editing Block.....	3- 4
3.3.6 Printer unit Output Image Processing.....	3- 5

3.4 Flow of Image Data	3- 5
3.4.1 Flow of Image Data According to Copy Functions	3- 5
3.4.2 Flow of Image Data for the SEND Function	3- 6
3.4.3 Flow of Image Data for the Fax Transmission	3- 6
3.4.4 Flow of Image Data for the Fax Reception Function.....	3- 7
3.4.5 Flow of Image Data for the PDL Function.....	3- 7
3.5 Parts Replacement Procedure	3- 9
3.5.1 Main Controller PCB	3- 9
3.5.1.1 Removing the Rear Cover	3- 9
3.5.1.2 Removing the Left Cover (Rear)	3- 9
3.5.1.3 Removing the RAM Cover.....	3- 9
3.5.1.4 Removing the SDRAM.....	3- 9
3.5.1.5 Removing the LAN Cover.....	3- 9
3.5.1.6 Removing the IP Cover.....	3- 9
3.5.1.7 Removing the IP Cover.....	3- 10
3.5.1.8 Removing the image processor PCB	3- 11
3.5.1.9 Procedure after Replacing the Image Processor PCB	3- 11
3.5.2 SDRAM	3- 11
3.5.2.1 Removing the Rear Cover	3- 11
3.5.2.2 Removing the RAM Cover.....	3- 11

Chapter 4 Original Exposure System

4.1 Construction.....	4- 1
4.1.1 Specifications, Control Methods, and Functions	4- 1
4.1.2 Major Components	4- 1
4.1.3 Control System Configuration.....	4- 2
4.1.4 Reader Controller PCB	4- 2
4.2 Basic Sequence	4- 3
4.2.1 Basic Sequence at Power-on	4- 3
4.2.2 Basic Sequence after Depression of Start Key (Book mode, One Sheet of original).....	4- 4
4.2.3 Basic Sequence after Depression of Start Key (ADF Mode, One Sheet of Original).....	4- 4
4.3 Various Control	4- 5
4.3.1 Controlling the Scanner Drive System.....	4- 5
4.3.1.1 Outline	4- 5
4.3.1.2 Reader Motor Control.....	4- 6
4.3.2 Contact Image Sensor (CIS)	4- 6
4.3.2.1 Outline	4- 6
4.3.2.2 Analog Control Performed by the CIS	4- 7
4.3.3 Enlargement/Reduction	4- 8
4.3.3.1 Magnification Change in Vertical Scan Direction.....	4- 8
4.3.3.2 Magnification Change in Horizontal Scan Direction	4- 8
4.3.4 Detecting the Size of Originals.....	4- 8
4.3.4.1 Outline	4- 8
4.3.4.2 Outline of Original Size Detection	4- 9
4.3.5 Dirt Sensor Control.....	4- 10
4.3.5.1 Outline	4- 10
4.3.6 Image Processing.....	4- 11
4.3.6.1 Outline	4- 11

4.3.6.2 CMOS Sensor Drive	4- 12
4.3.6.3 CMOS Sensor Output Gain Correction and Offset Correction	4- 13
4.3.6.4 CMOS Sensor Output A/D Conversion	4- 13
4.3.6.5 Shading Correction (Outline)	4- 13
4.3.6.6 Shading Adjustment.....	4- 13
4.3.6.7 Shading Correction	4- 13
4.4 Parts Replacement Procedure.....	4- 14
4.4.1 Copyboard glass.....	4- 14
4.4.1.1 Removing the Copyboard glass.....	4- 14
4.4.1.2 Removing the ADF Reading Glass	4- 14
4.4.2 Reader Controller PCB.....	4- 14
4.4.2.1 Removing the Rear Cover	4- 14
4.4.2.2 Removing the Right Cover (Lower).....	4- 14
4.4.2.3 Removing the Right Cover (Upper).....	4- 15
4.4.2.4 Removing the Left Cover (Rear).....	4- 15
4.4.2.5 Removing the Reader Rear Cover.....	4- 15
4.4.2.6 Removing the Copyboard glass.....	4- 15
4.4.2.7 Removing the Reader Controller PCB.....	4- 16
4.4.3 Scanner Motor.....	4- 17
4.4.3.1 Removing the Rear Cover	4- 17
4.4.3.2 Removing the Right Cover (Lower).....	4- 17
4.4.3.3 Removing the Right Cover (Upper).....	4- 17
4.4.3.4 Removing the Left Cover (Rear).....	4- 17
4.4.3.5 Removing the Reader Rear Cover.....	4- 18
4.4.3.6 Removing the Scanner Motor	4- 18
4.4.4 Contact sensor	4- 18
4.4.4.1 Removing the Rear Cover	4- 18
4.4.4.2 Removing the Right Cover (Lower).....	4- 18
4.4.4.3 Removing the Right Cover (Upper).....	4- 19
4.4.4.4 Removing the Left Cover (Rear).....	4- 19
4.4.4.5 Removing the Reader Rear Cover.....	4- 19
4.4.4.6 Removing the Copyboard glass.....	4- 19
4.4.4.7 Removing the Contact Image Sensor (CIS)	4- 20
4.4.4.8 Procedure after Replacing the CIS	4- 20
4.4.5 Copyboard Cover Open/Close Sensor.....	4- 20
4.4.5.1 Removing the Rear Cover	4- 20
4.4.5.2 Removing the Right Cover (Lower).....	4- 21
4.4.5.3 Removing the Right Cover (Upper).....	4- 21
4.4.5.4 Removing the Left Cover (Rear).....	4- 21
4.4.5.5 Removing the Reader Rear Cover.....	4- 21
4.4.5.6 Removing the Copyboard Cover Open/Close Sensor (Front/Rear)	4- 22
4.4.6 Contact Sensor HP Sensor.....	4- 22
4.4.6.1 Removing the Copyboard glass.....	4- 22
4.4.6.2 Removing the ADF Reading Glass	4- 22
4.4.6.3 Removing the Contact Sensor HP Sensor.....	4- 23
4.4.7 Original Size Sensor	4- 23
4.4.7.1 Removing the Copyboard glass.....	4- 23
4.4.7.2 Removing the Original Sensor (Vertical Scan Direction).....	4- 23
4.4.7.3 Removing the Original Sensor (Horizontal Scan Direction)	4- 24

4.4.8 Reader Heater (option).....	4- 24
4.4.8.1 Removing the Copyboard glass	4- 24
4.4.8.2 Removing the Reader Heater (Right).....	4- 25
4.4.8.3 Removing the Reader Front Cover.....	4- 25
4.4.8.4 Removing the ADF Reading Glass.....	4- 25
4.4.8.5 Removing the Reader Heater (Left).....	4- 26

Chapter 5 Laser Exposure

5.1 Construction.....	5- 1
5.1.1 Overview	5- 1
5.1.2 Specifications and Control Mechanism	5- 1
5.1.3 Specifications and Control Mechanism	5- 1
5.1.4 Main Components.....	5- 1
5.1.5 Control System Configuration.....	5- 2
5.2 Various Controls	5- 3
5.2.1 Controlling the Laser Activation Timing	5- 3
5.2.1.1 Laser Emission ON/OFF Control	5- 3
5.2.1.2 Laser Emission ON/OFF Control	5- 3
5.2.1.3 Horizontal Synchronization Control	5- 4
5.2.1.4 Horizontal Synchronization Control	5- 4
5.2.2 Controlling the Intensity of Laser Light	5- 4
5.2.2.1 Automatic Photocurrent Control (APC)	5- 4
5.2.3 Controlling the Laser Scanner Motor	5- 4
5.2.3.1 Laser Scanner Motor Control.....	5- 4
5.2.4 Controlling the Laser Shutter.....	5- 5
5.2.4.1 Laser Shutter Control	5- 5
5.3 Parts Replacement Procedure	5- 7
5.3.1 Laser Scanner Unit	5- 7
5.3.1.1 Removing the Rear Cover.....	5- 7
5.3.1.2 Removing the Right Cover (Lower)	5- 7
5.3.1.3 Removing the Delivery Tray.....	5- 7
5.3.1.4 Removing the Laser Scanner Unit.....	5- 7

Chapter 6 Image Formation

6.1 Construction.....	6- 1
6.1.1 Specifications of Image Formation System	6- 1
6.1.2 Major Components of Image Formation System	6- 1
6.2 Image Formation Process	6- 1
6.2.1 Image Formation Process	6- 1
6.3 Basic Sequence	6- 2
6.3.1 Basic Sequence of Operation.....	6- 2
6.4 Driving and Controlling the High-Voltage System	6- 3
6.4.1 Outline	6- 3
6.5 Drum Unit.....	6- 4
6.5.1 Outline of the Drum Unit.....	6- 4
6.5.1.1 Outline	6- 4
6.5.2 Charging Mechanism.....	6- 4

6.5.2.1 Primary Charging Bias Control	6- 4
6.6 Developing Unit	6- 5
6.6.1 Outline	6- 5
6.6.2 Developing Bias Control	6- 5
6.7 Toner Container	6- 6
6.7.1 Outline	6- 6
6.8 Transfer Unit	6- 6
6.8.1 Outline of the Transfer Unit	6- 6
6.8.1.1 Outline	6- 6
6.8.2 Controlling the Transfer Bias	6- 7
6.8.2.1 Transfer Roller Bias Control	6- 7
6.8.3 Separation Mechanism	6- 7
6.8.3.1 Static Eliminator Bias Control	6- 7
6.9 Photosensitive Drum Cleaning	6- 8
6.9.1 Outline	6- 8
6.9.2 Waste Toner Full Detection	6- 8
6.10 Parts Replacement Procedure	6- 9
6.10.1 Drum Unit	6- 9
6.10.1.1 Removing the Drum Unit	6- 9
6.10.2 Developing Assembly	6- 9
6.10.2.1 Removing the Drum Unit	6- 9
6.10.2.2 Removing the Rear Cover	6- 9
6.10.2.3 Removing the Right Cover (Lower)	6- 9
6.10.2.4 Removing the Delivery Tray	6- 9
6.10.2.5 Removing the Developing Assembly	6- 9
6.10.2.6 Precautions about Installation of Developing Assembly	6- 10
6.10.2.7 Procedure after Replacing the Developing Assembly	6- 10
6.10.3 Transfer Charging Roller	6- 10
6.10.3.1 Removing the Transfer Charging Roller	6- 10

Chapter 7 Pickup/Feeding System

7.1 Construction	7- 1
7.1.1 Specifications/Configuration/Operation Methods	7- 1
7.1.2 Locations of Main Units	7- 1
7.1.3 Roller Layout Drawing	7- 1
7.1.4 Paper Path Drawing(Printer on its own)	7- 2
7.1.5 Paper Path Drawing(Finisher-U1)	7- 3
7.1.6 Paper Path Drawing(Duplex Unit-A1/Finisher-U1)	7- 3
7.1.7 Paper Path Drawing(Duplex-A1)	7- 3
7.1.8 Paper Path Drawing(Duplex-A1/Inner 2Way Tray-E1)	7- 4
7.1.9 Paper Path Drawing(Inner 2Way Tray-E1)	7- 4
7.1.10 Sensor Layout Drawing	7- 5
7.2 Detecting Jams	7- 6
7.2.1 Delay Jams	7- 6
7.2.1.1 Delay Jam in Pickup Assembly	7- 6
7.2.1.2 Delay Jam in Delivery Assembly (Paper Leading Edge Jam at Delivery Sensor/Wound Paper Jam at Fixing Assembly)	7- 6
7.2.2 Stationary Jams	7- 6

7.2.2.1 Stationary Jam in Pickup Assembly.....	7- 6
7.2.2.2 Stationary Jam in Delivery Assembly (Paper Trailing Edge Stationary Jam at Delivery Sensor/ Stationary Jam at Delivery Sensor)	7- 6
7.2.3 Other Jams	7- 6
7.2.3.1 Door Open Jam.....	7- 6
7.3 Cassette Pick-Up Unit.....	7- 6
7.3.1 Overview	7- 6
7.3.2 Cassette Pickup Operation	7- 7
7.3.3 Cassette Paper Size Detection.....	7- 8
7.4 Manual Feed Pickup Unit	7- 9
7.4.1 Overview	7- 9
7.4.2 Post-pickup Control after Multi Manual Feed Pickup.....	7- 9
7.5 Parts Replacement Procedure	7- 10
7.5.1 Pickup Roller.....	7- 10
7.5.1.1 Removing the Cassette Paper Pickup Roller	7- 10
7.5.2 Cassette Pickup Assembly	7- 10
7.5.2.1 Removing the Lower-left Cover.....	7- 10
7.5.2.2 Removing the Cassette Pickup AssemblyÇµ.....	7- 10
7.5.3 Cassette Size Sensor	7- 10
7.5.3.1 Removing the Paper Size Detection Switches.....	7- 10
7.5.4 Cassette Retry Paper Sensor.....	7- 10
7.5.4.1 Removing the Cassette Pickup Assembly.....	7- 10
7.5.4.2 Removing the Retry Sensor.....	7- 11
7.5.5 Cassette Paper Sensor	7- 11
7.5.5.1 Removing the Cassette Pickup Assembly	7- 11
7.5.5.2 Removing the Cassette Paper Presence/Absence Sensor	7- 11
7.5.6 Cassette Pickup Solenoid.....	7- 11
7.5.6.1 Removing the Cassette Pickup Assembly.....	7- 11
7.5.6.2 Removing the Cassette Pickup Solenoid.....	7- 12
7.5.7 Manual Feed Tray sensor	7- 12
7.5.7.1 Removing the Drum Unit	7- 12
7.5.7.2 Removing the Transfer Registration Unit.....	7- 12
7.5.7.3 Removing the Feed Guide	7- 12
7.5.7.4 Removing the Multifeeder Paper Presence/Absence Sensor	7- 12
7.5.8 Manual Feed Pickup Solenoid	7- 13
7.5.8.1 Removing the Drum Unit	7- 13
7.5.8.2 Removing the Transfer Registration Unit.....	7- 13
7.5.8.3 Removing the Feed Guide	7- 13
7.5.8.4 Removing the Multifeeder Connector Cover	7- 13
7.5.8.5 Removing the Multifeeder Unit	7- 13
7.5.8.6 Removing the Multifeeder Pickup Solenoid.....	7- 13
7.5.9 Registration Roller.....	7- 14
7.5.9.1 Removing the Drum Unit	7- 14
7.5.9.2 Removing the Registration Roller	7- 14
7.5.10 Registration Clutch.....	7- 14
7.5.10.1 Removing the Rear Cover.....	7- 14
7.5.10.2 Removing the Registration Clutch	7- 14
7.5.11 Separation Roller.....	7- 15
7.5.11.1 Removing the Feed and Separation Rollers	7- 15

7.5.12 Separation Pad	7- 15
7.5.12.1 Removing the Drum Unit.....	7- 15
7.5.12.2 Removing the Transfer Registration Unit.....	7- 15
7.5.12.3 Removing the Feed Guide.....	7- 15
7.5.12.4 Removing the Multifeeder Pickup Roller	7- 15
7.5.12.5 Removing the Separation Pad.....	7- 16

Chapter 8 Fixing System

8.1 Construction.....	8- 1
8.1.1 Specifications, Control Mechanisms, and Functions.....	8- 1
8.1.2 Major Components.....	8- 2
8.2 Various Control Mechanisms	8- 3
8.2.1 Controlling the Speed of the Fixing Film.....	8- 3
8.2.1.1 Controlling the Fixing Film Speed	8- 3
8.2.2 Controlling the Fixing Film Temperature.....	8- 3
8.2.2.1 Outline.....	8- 3
8.2.2.2 Controlling the Fixing Film Temperature	8- 3
8.2.2.3 Target Temperatures by Mode	8- 4
8.2.3 Detecting the Passage of Paper	8- 4
8.2.3.1 Detecting the Passage of Paper.....	8- 4
8.3 Protective Functions.....	8- 5
8.3.1 Protective Functions.....	8- 5
8.4 Parts Replacement Procedure.....	8- 7
8.4.1 Fixing Unit.....	8- 7
8.4.1.1 Removing the Drum Unit.....	8- 7
8.4.1.2 Removing the rear cover.....	8- 7
8.4.1.3 Removing the Left Cover (Rear).....	8- 7
8.4.1.4 Removing the Left Door	8- 7
8.4.1.5 Removing the Fixing Unit.....	8- 8
8.4.2 Pressure Roller	8- 9
8.4.2.1 Removing the Drum Unit.....	8- 9
8.4.2.2 Removing the rear cover.....	8- 9
8.4.2.3 Removing the Left Cover (Rear).....	8- 9
8.4.2.4 Removing the Left Door	8- 9
8.4.2.5 Removing the Fixing Unit.....	8- 10
8.4.2.6 Removing the Fixing Film Unit.....	8- 10
8.4.2.7 Removing the Pressure Roller.....	8- 12
8.4.3 Fixing Film.....	8- 13
8.4.3.1 Removing the Drum Unit.....	8- 13
8.4.3.2 Removing the rear cover.....	8- 13
8.4.3.3 Removing the Left Cover (Rear).....	8- 13
8.4.3.4 Removing the Left Door	8- 13
8.4.3.5 Removing the Fixing Unit.....	8- 14
8.4.3.6 Removing the Fixing Film Unit.....	8- 15
8.4.4 Fixing Delivery Sensor	8- 17
8.4.4.1 Removing the Drum Unit.....	8- 17
8.4.4.2 Removing the Rear Cover	8- 17
8.4.4.3 Removing the Left Cover (Rear).....	8- 17

8.4.4.4 Removing the Left Door	8- 17
8.4.4.5 Removing the Fixing Unit	8- 18
8.4.4.6 Removing the Fixing Delivery Sensor	8- 18
8.4.5 Fixing Film Sensor	8- 19
8.4.5.1 Removing the Drum Unit	8- 19
8.4.5.2 Removing the Rear Cover	8- 19
8.4.5.3 Removing the Left Cover (Rear)	8- 20
8.4.5.4 Removing the Left Door	8- 20
8.4.5.5 Removing the Fixing Unit	8- 20
8.4.5.6 Removing the Fixing Film Sensor	8- 21

Chapter 9 External and Controls

9.1 Control Panel	9- 1
9.1.1 Overview	9- 1
9.2 Fans	9- 1
9.2.1 Overview	9- 1
9.2.2 Fan Control	9- 1
9.3 Power Supply System	9- 2
9.3.1 Power Supply	9- 2
9.3.1.1 Outline	9- 2
9.3.1.2 Rated Output of the Power Supply PCB	9- 2
9.4 Parts Replacement Procedure	9- 3
9.4.1 Main Drive Assembly	9- 3
9.4.1.1 Removing the Drum Unit	9- 3
9.4.1.2 Removing the Rear Cover	9- 3
9.4.1.3 Removing the Left Cover (Rear)	9- 3
9.4.1.4 Removing the Main Motor	9- 3
9.4.1.5 Removing the Registration Clutch	9- 3
9.4.1.6 Removing the Main Drive Unit	9- 4
9.4.2 Fixing Drive Assembly	9- 5
9.4.2.1 Removing the Drum Unit	9- 5
9.4.2.2 Removing the Rear Cover	9- 5
9.4.2.3 Removing the Left Cover (Rear)	9- 5
9.4.2.4 Removing the Left Door	9- 5
9.4.2.5 Removing the Fixing Unit	9- 6
9.4.2.6 Removing the SDRAM	9- 7
9.4.2.7 Removing the SDRAM	9- 7
9.4.2.8 Removing the LAN Cover	9- 7
9.4.2.9 Removing the IP Cover	9- 7
9.4.2.10 Removing the IP Cover	9- 8
9.4.2.11 Removing the Image Processor PCB Mount	9- 8
9.4.2.12 Removing the Fixing Drive Unit	9- 9
9.4.3 Power Supply Unit	9- 10
9.4.3.1 Removing the Rear Cover	9- 10
9.4.3.2 Removing the Right Cover (Lower)	9- 10
9.4.3.3 Removing the Delivery Tray	9- 10
9.4.3.4 Removing the Main Power Supply PCB	9- 10
9.4.4 Control Panel	9- 10

9.4.4.1 Removing the Reader Front Cover	9- 10
9.4.4.2 Removing the Operation Panel Unit	9- 11
9.4.5 DC Controller PCB	9- 11
9.4.5.1 Removing the Rear Cover	9- 11
9.4.5.2 Removing the DC Controller PCB	9- 11
9.4.6 Option Power Supply PCB	9- 11
9.4.6.1 Removing the Rear Cover	9- 11
9.4.6.2 Removing the Right Cover (Lower)	9- 11
9.4.6.3 Removing the Delivery Tray	9- 11
9.4.6.4 Removing the Option Power Supply PCB	9- 12
9.4.7 HVT PCB	9- 12
9.4.7.1 Removing the Rear Cover	9- 12
9.4.7.2 Removing the Right Cover (Lower)	9- 12
9.4.7.3 Removing the Delivery Tray	9- 12
9.4.7.4 Removing the Main Power Supply PCB	9- 12
9.4.7.5 Removing the HVT PCB	9- 13
9.4.8 Fixing Heat Discharge Fan	9- 13
9.4.8.1 Removing the Fixing Heat Discharge Fan	9- 13
9.4.9 Fan Filter	9- 14
9.4.9.1 Removing the Fan Filter	9- 14
9.4.10 Motor of Main Drive Assembly	9- 14
9.4.10.1 Removing the Rear Cover	9- 14
9.4.10.2 Removing the Main Motor	9- 14
9.4.11 Fixing Driver Motor	9- 15
9.4.11.1 Removing the Rear Cover	9- 15
9.4.11.2 Removing the Left Cover (Rear)	9- 15
9.4.11.3 Removing the RAM Cover	9- 15
9.4.11.4 Removing the SDRAM	9- 15
9.4.11.5 Removing the LAN Cover	9- 15
9.4.11.6 Removing the IP Cover	9- 15
9.4.11.7 Removing the IP Cover	9- 16
9.4.11.8 Removing the Image Processor PCB Mount	9- 17
9.4.11.9 Removing the Fixing Unit Drive Motor	9- 18
9.4.12 Left Door	9- 18
9.4.12.1 Removing the Drum Unit	9- 18
9.4.12.2 Removing the Rear Cover	9- 18
9.4.12.3 Removing the Left Cover (Rear)	9- 18
9.4.12.4 Removing the Left Door	9- 18

Chapter 10 Maintenance and Inspection

10.1 Periodically Replaced Parts	10- 1
10.1.1 Overview	10- 1
10.1.2 Reader Unit	10- 1
10.1.3 Printer Unit	10- 1
10.2 Durables and Consumables	10- 1
10.2.1 Overview	10- 1
10.2.2 Reader Unit	10- 1
10.2.3 Printer Unit	10- 1

10.3 Scheduled Servicing Basic Procedure	10- 2
10.3.1 Scheduled Servicing.....	10- 2

Chapter 11 Standards and Adjustments

11.1 Scanning System.....	11- 1
11.1.1 Procedure after Replacing the CIS.....	11- 1
11.2 Image Formation System	11- 1
11.2.1 Procedure after Replacing the Developing Assembly	11- 1
11.3 Electrical Components.....	11- 1
11.3.1 Procedure after Replacing the Image Processor PCB	11- 1

Chapter 12 Correcting Faulty Images

12.1 Making Initial Checks	12- 1
12.1.1 Site Environment.....	12- 1
12.1.2 Checking the Paper	12- 1
12.1.3 Checking the Placement of Paper	12- 1
12.1.4 Checking the Durables.....	12- 1
12.1.5 Checking the Units and Functional Systems.....	12- 1
12.1.6 Others	12- 2
12.2 Outline of Electrical Components.....	12- 2
12.2.1 Clutch/Solenoid.....	12- 2
12.2.1.1 List of Clutches/Solenoids	12- 2
12.2.2 Motor	12- 2
12.2.2.1 List of Motors	12- 2
12.2.3 Fan.....	12- 3
12.2.3.1 List of Fans	12- 3
12.2.4 Sensor.....	12- 4
12.2.4.1 List of Sensors.....	12- 4
12.2.5 Switch.....	12- 6
12.2.5.1 List of Switches	12- 6
12.2.6 Lamps, Heaters, and Others	12- 6
12.2.6.1 List of Lamps, Heaters, and Others	12- 6

Chapter 13 Self Diagnosis

13.1 Error Code Table	13- 1
13.1.1 List of Error Codes.....	13- 1
13.2 Error Code Details	13- 1
13.2.1 Error Code Details	13- 1
13.3 Jam Code.....	13- 3
13.3.1 Jam Codes (Related to Printer Unit).....	13- 3
13.3.2 Jam Codes (Related to Finisher)	13- 3
13.3.3 Jam Codes (Related to ADF).....	13- 4
13.3.4 Jam Codes (Related to Duplex Unit).....	13- 4
13.3.5 Jam Codes (Related to Inner 2-way Tray).....	13- 4
13.4 Finisher Error Codes	13- 4
13.4.1 Error Code Details	13- 4

13.5 FAX Error Codes	13- 8
13.5.1 Outline	13- 8
13.5.1.1 Error Code Outline	13- 8
13.5.2 User Error Code	13- 8
13.5.2.1 User Error Code	13- 8
13.5.3 Service Error Code	13- 8
13.5.3.1 Service Error Code	13- 8

Chapter 14 Service Mode

14.1 Outline	14- 1
14.1.1 Outline of Service Mode	14- 1
14.1.2 Using the Mode	14- 1
14.2 Default settings	14- 2
14.2.1 Service Mode Menus	14- 2
14.3 Setting of Bit Switch (SSSW)	14- 7
14.3.1 Outline	14- 7
14.3.1.1 Bit Switch Composition	14- 7
14.3.2 SSSW-SW01	14- 7
14.3.2.1 List of Functions	14- 7
14.3.2.2 Detailed Discussions of Bit 0	14- 7
14.3.3 SSSW-SW03	14- 7
14.3.3.1 List of Functions	14- 7
14.3.3.2 Detailed Discussions of Bit 7	14- 7
14.3.4 SSSW-SW04	14- 7
14.3.4.1 List of Functions	14- 7
14.3.4.2 Detailed Discussions of Bit 2	14- 8
14.3.4.3 Detailed Discussions of Bit 3	14- 8
14.3.4.4 Detailed Discussions of Bit 4	14- 8
14.3.4.5 Detailed Discussions of Bit 6	14- 8
14.3.4.6 Detailed Discussions of Bit 7	14- 8
14.3.5 SSSW-SW05	14- 8
14.3.5.1 List of Functions	14- 8
14.3.5.2 Detailed Discussions of Bit 1	14- 8
14.3.5.3 Detailed Discussions of Bit 2	14- 9
14.3.6 SSSW-SW12	14- 9
14.3.6.1 List of Functions	14- 9
14.3.7 SSSW-SW13	14- 9
14.3.7.1 List of Functions	14- 9
14.3.7.2 Detailed Discussions of Bit 2	14- 9
14.3.8 SSSW-SW14	14- 10
14.3.8.1 List of Functions	14- 10
14.3.8.2 Detailed Discussions of Bit 2	14- 10
14.3.8.3 Detailed Discussions of Bit 4	14- 10
14.3.9 SSSW-SW28	14- 10
14.3.9.1 List of Functions	14- 10
14.3.9.2 Detailed Discussions of Bit 0	14- 10
14.3.9.3 Detailed Discussions of Bit 1	14- 10
14.3.9.4 Detailed Discussions of Bit 2	14- 10

14.3.9.5 Detailed Discussions of Bit 3	14- 10
14.3.9.6 Detailed Discussions of Bit 4	14- 10
14.3.9.7 Detailed Discussions of Bit 5	14- 10
14.3.10 SSSW-SW30.....	14- 11
14.3.10.1 List of Functions	14- 11
14.3.10.2 Detailed Discussions of Bit 5	14- 11
14.3.11 SSSW-SW33.....	14- 11
14.3.11.1 List of Functions	14- 11
14.3.11.2 Detailed Discussions of Bit 0	14- 11
14.3.11.3 Detailed Discussions of Bit 1	14- 11
14.3.11.4 Detailed Discussions of Bit 2	14- 11
14.3.11.5 Detailed Discussions of Bit 3	14- 11
14.3.12 SSSW-SW34.....	14- 11
14.3.12.1 List of Functions	14- 11
14.3.12.2 Detailed Discussions of Bit 0	14- 12
14.3.12.3 Detailed Discussions of Bit 1	14- 12
14.4 Setting of Menu Switch (Menu)	14- 12
14.4.1 Menu Switch Composition.....	14- 12
14.4.2 <No.005 NL equalizer>	14- 12
14.4.3 <No.006 telephone line monitor>	14- 12
14.4.4 <No.007 ATT transmission level>	14- 12
14.4.5 <No.008 V.34 modulation speed upper limit>	14- 13
14.4.6 <No.009 V.34 data speed upper limit>	14- 13
14.4.7 <No.010 Frequency of the pseudo CI signal>	14- 13
14.5 Setting of Numeric Parameter (NUMERIC Param.).....	14- 13
14.5.1 Numerical Parameter Composition.....	14- 13
14.5.2 <002: RTN transmission condition (1)><003: RTN transmission condition (2)><004: RTN transmission condition (3)>	14- 13
14.5.3 <005: NCC pause length (pre-ID code)>	14- 14
14.5.4 <006: NCC pause length (post-ID code)>	14- 14
14.5.5 <010: line connection identification length>	14- 14
14.5.6 <011: T.30 T1 timer (for reception)>	14- 14
14.5.7 <013: T.30 EOL timer>	14- 14
14.5.8 <016: time length to first response at time of fax/tel switchover>	14- 14
14.5.9 <017: pseudo RBT signal pattern ON time length><018: pseudo RBT signal pattern OFF time length (short)><019: pseudo RBT signal pattern OFF time length (long)>	14- 14
14.5.10 <020: pseudo CI signal pattern ON time length><021: pseudo CI signal pattern OFF time length (short)><022: pseudo CI signal pattern OFF time length (long)>	14- 14
14.5.11 <023: CNG detention level for fax/tel switchover>	14- 14
14.5.12 <024: pseudo RBT transmission level at time of fax/tel switchover>	14- 14
14.5.13 <025: Answering machine connection function signal detection time>	14- 14
14.5.14 <027: V.21 low-speed flag preamble identification length>	14- 14
14.5.15 <056 - 061: Count type select >	14- 14
14.6 Setting of Scanner Functions (SCANNER)	14- 17
14.6.1 Setting of Bit Switch	14- 17
14.6.2 Numeric Parameter Functional configuration.....	14- 18
14.6.3 <024:CIS scan position during ADF scanning>	14- 18
14.6.4 <026:Distance from the standby position of CIS to the shading start point>	14- 19
14.6.5 <031Vertical scan start position adjustment>	14- 19

14.6.6 <032Horizontal scan start position adjustment>	14- 19
14.6.7 <033Vertical scan magnification correction>	14- 19
14.6.8 <035: - 036:Reader motor speed change>	14- 19
14.6.9 <041: Vertical scan start position adjustment (when scanning on a document fed from ADF)> 14- 19	
14.6.10 <042: Horizontal scan start position adjustment (when scanning on a document fed from ADF)> 14- 19	
14.6.11 <043: Horizontal scan end position correction (copy)>	14- 19
14.6.12 <044: Horizontal scan end position correction (superfine)>	14- 19
14.6.13 <045: Horizontal scan end position correction (fine)>	14- 19
14.6.14 <046: Horizontal scan end position correction (standard)>	14- 19
14.6.15 <047: Vertical scan magnification correction (when scanning on a document fed from ADF)> ... 14- 19	
14.6.16 <048: Horizontal scan magnification correction (when scanning on a document fed from ADF)> 14- 19	
14.6.17 <054: Pickup motor speed correction (when the ADF is used) >	14- 20
14.6.18 <193: ADF special standard-sized paper: LGL misidentification-ready>	14- 20
14.6.19 <194: ADF special standard-sized paper: LTR misidentification-ready>	14- 20
14.6.20 <195: ADF special standard-sized paper: LTR_R misidentification-ready>	14- 20
14.6.21 <196: Shading Target Value (Red)>	14- 20
14.6.22 <197: Shading Target Value (Green)>	14- 20
14.6.23 <198: Shading Target Value (Blue)>	14- 20
14.7 Setting of Printer Functions (PRINTER).....	14- 20
14.7.1 Service Soft Switch Settings (PRINTER).....	14- 20
14.7.1.1 SSSW-SW05	14- 20
14.7.1.2 SSSW-SW14	14- 21
14.7.1.3 SSSW-SW15	14- 22
14.7.2 Numerin Parameter Settings (Numeric Prama.).....	14- 22
14.7.2.1 List of Functions	14- 22
14.7.2.2 <031: Top registration adjustment (manual feed tray)>	14- 23
14.7.2.3 <032: Top registration adjustment (cassette)>	14- 23
14.7.2.4 <033: Top registration adjustment (duplex unit)>	14- 23
14.7.2.5 <034: Left-end registration adjustment (manual feed tray)>	14- 23
14.7.2.6 <035: Left-end registration adjustment (cassette 1)>.....	14- 23
14.7.2.7 <036: Left-end registration adjustment (cassette 2)>.....	14- 23
14.7.2.8 <037: Left-end registration adjustment (cassette 3)>.....	14- 23
14.7.2.9 <038: Left-end registration adjustment (cassette 4)>.....	14- 23
14.7.2.10 <039: Left-end registration adjustment (duplex unit)>	14- 23
14.7.2.11 <040: Target fixing temperature adjustment (manual feed tray)>	14- 23
14.7.2.12 <041: Target fixing temperature adjustment (cassette 1)>	14- 23
14.7.2.13 <042: Target fixing temperature adjustment (cassette 2)>	14- 23
14.7.2.14 <043: Target fixing temperature adjustment (cassette 3)>	14- 23
14.7.2.15 <044: Target fixing temperature adjustment (cassette 4)>	14- 23
14.7.2.16 <045: Fixing film speed change (manual feed tray)>	14- 24
14.7.2.17 <046: Fixing film speed change (cassette)>	14- 24
14.7.3 Setting of Cassette (CST)	14- 24
14.7.3.1 Special Standard-sized Paper Compatibility	14- 24
14.8 Setting of System Functions (SYSTEM)	14- 24
14.8.1 Bit Switch Settings	14- 24

14.9 Registration of Accessories (ACC)	14- 24
14.9.1 Accessory Registration	14- 24
14.10 Display of Counter Information (COUNTER)	14- 25
14.10.1 Counters	14- 25
14.10.2 Clearing Counters	14- 25
14.11 Service Report (REPORT)	14- 26
14.11.1 Report Output	14- 26
14.11.2 System Data List	14- 26
14.11.3 System Dump List	14- 26
14.11.4 Counter List	14- 28
14.11.5 Error Log List	14- 28
14.11.6 Spec List	14- 30
14.11.7 Service Label	14- 31
14.12 Download (DOWNLOAD)	14- 32
14.12.1 Download	14- 32
14.13 Initialization of Set Value (CLEAR)	14- 32
14.13.1 Clear	14- 32
14.14 Display of ROM Information (ROM)	14- 32
14.14.1 ROM display	14- 32
14.15 Test Mode (TEST)	14- 33
14.15.1 Outline	14- 33
14.15.2 Test Mode Menu List	14- 33
14.15.3 D-RAM test<(1) D-RAM TEST>	14- 35
14.15.4 Scan Test ((2) SCAN TEST)	14- 35
14.15.5 Print Test ((3) PRINT TEST)	14- 36
14.15.6 MODEM Test((4) MODEM TEST)	14- 36
14.15.7 Function test ((6) FUNCTION TEST)	14- 38
14.15.8 Roller cleaning mode ((0) ROLLER CLEAN)	14- 42

Chapter 15 Upgrading

15.1 Outline	15- 1
15.1.1 Overview of Upgrade	15- 1
15.1.2 Overview of Service Support Tool	15- 1
15.2 Making Preparations	15- 1
15.2.1 Registering the System Software	15- 1
15.2.2 Connection	15- 3
15.3 Downloading System Software	15- 4
15.3.1 Downloading System	15- 4
15.3.1.1 Downloading Procedure	15- 4
15.3.2 Downloading BOOT	15- 9
15.3.2.1 Downloading Procedure	15- 9
15.3.3 Other Upgrade Methods	15- 9
15.3.3.1 Downloading the PCL Software	15- 9

Chapter 1 Introduction

Contents

1.1 System Construction.....	1-1
1.1.1 Pickup/ Delivery /Original Handling Accessories System Configuration (iR2020/iR2020J)	1-1
1.1.2 Pickup/ Delivery /Original Handling Accessories System Configuration (iR2016/iR2016J)	1-2
1.1.3 Reader Heater/ Cassette Heater System Configuration.....	1-3
1.1.4 Printing/Transmitting Accessories System Configuration (iR2020J/iR2016J).....	1-3
1.1.5 Printing/Transmitting Accessories System Configuration (iR2020/iR2016).....	1-4
1.1.6 Functions of the Printing/Transmission Functions (iR2020/iR2016)	1-4
1.2 Product Specifications	1-5
1.2.1 Names of Parts.....	1-5
1.2.1.1 External View (iR2020/iR2020J)	1-5
1.2.1.2 External View (iR2016/iR2016J)	1-6
1.2.1.3 Cross-Section.....	1-7
1.2.2 Using the Machine.....	1-8
1.2.2.1 Turning On the Power Switch	1-8
1.2.2.2 When Turning Off the Main Power Switch	1-9
1.2.2.3 Control Panel	1-10
1.2.3 User Mode Items	1-11
1.2.3.1 Common Settings	1-11
1.2.3.2 Copy Settings.....	1-11
1.2.3.3 FAX Settings	1-11
1.2.3.4 Address Book Set	1-12
1.2.3.5 Printer Settings	1-12
1.2.3.6 Timer Settings	1-13
1.2.3.7 Report Settings	1-13
1.2.3.8 Adjust./Cleaning.....	1-13
1.2.3.9 System Settings	1-13
1.2.4 Maintenance by the User	1-15
1.2.4.1 User Maintenance Items	1-15
1.2.4.2 Cleaning.....	1-15
1.2.5 Safety.....	1-16
1.2.5.1 Safety of the Laser Light	1-16
1.2.5.2 CDRH Regulations	1-16
1.2.5.3 Handling the Laser Unit	1-17
1.2.5.4 Safety of Toner	1-17
1.2.5.5 Point to Note about Fire	1-18
1.2.5.6 Cautions as to the replacement and disposal of lithium battery	1-18
1.2.6 Product Specifications	1-19
1.2.6.1 Product Specifications	1-19
1.2.7 Function List.....	1-20
1.2.7.1 Printing Speed (iR2020/iR2020J).....	1-20
1.2.7.2 Printing Speed (iR2016/iR2016J).....	1-21
1.2.7.3 Types of Paper.....	1-21

1.1 System Construction

1.1.1 Pickup/Delivery /Original Handling Accessories System Configuration (iR2020/iR2020J)

iR2020 /

The configuration is as shown in the following figure:

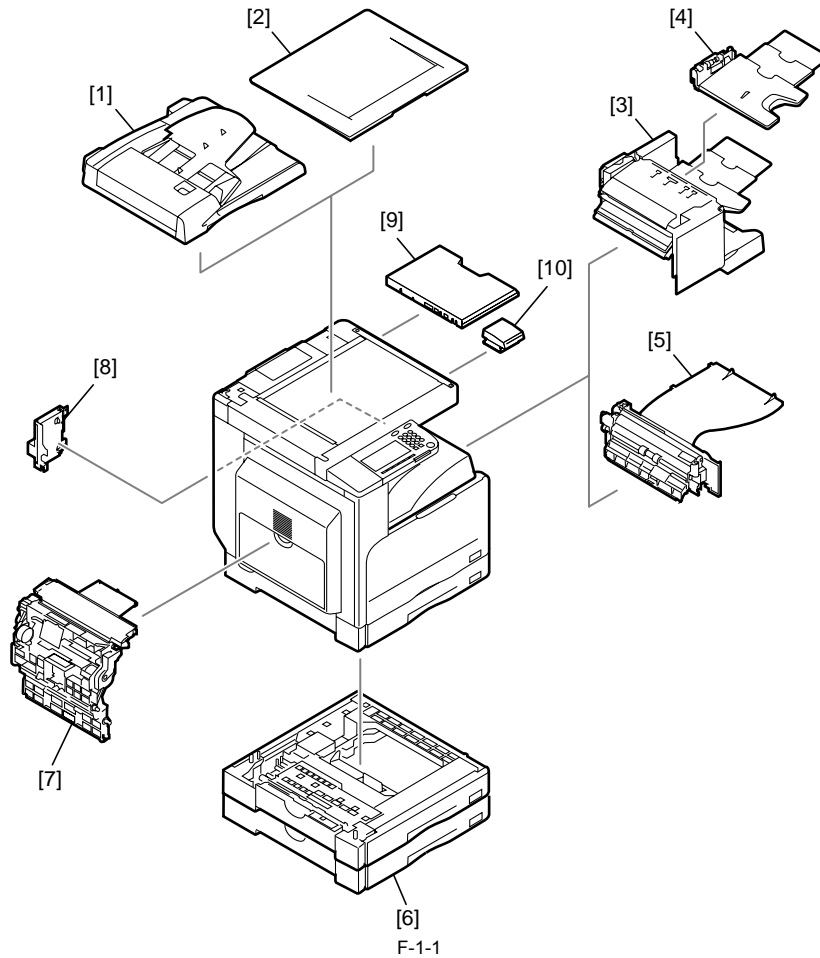

[1]	DADF-P1	
[2]	Platen Cover Type J	*1
[3]	Finisher-U1	
[4]	Additional Finisher Tray-C1	
[5]	Inner 2-way Tray-E1	
[6]	Cassette Feeding Module-K1	
[7]	Duplex Unit-A1	
[8]	Power Supply Kit-Q1	*2
[9]	Document Tray-J1	
[10]	Card Reader-E1	

*1: This accessory comes standard with the models for Asia excluding Taiwan and the models for some Latin American countries.

*2: This accessory is required when the Finisher-U1, Inner 2-way tray-E1, Cassette feeding module-K1, or Duplex unit-A1 is installed. This accessory comes standard with the iR2020 for North America, Latin America, and Asia.

1.1.2 Pickup/ Delivery /Original Handling Accessories System Configuration (iR2016/iR2016J)

iR2016J / iR2016

The configuration is as shown in the following figure:

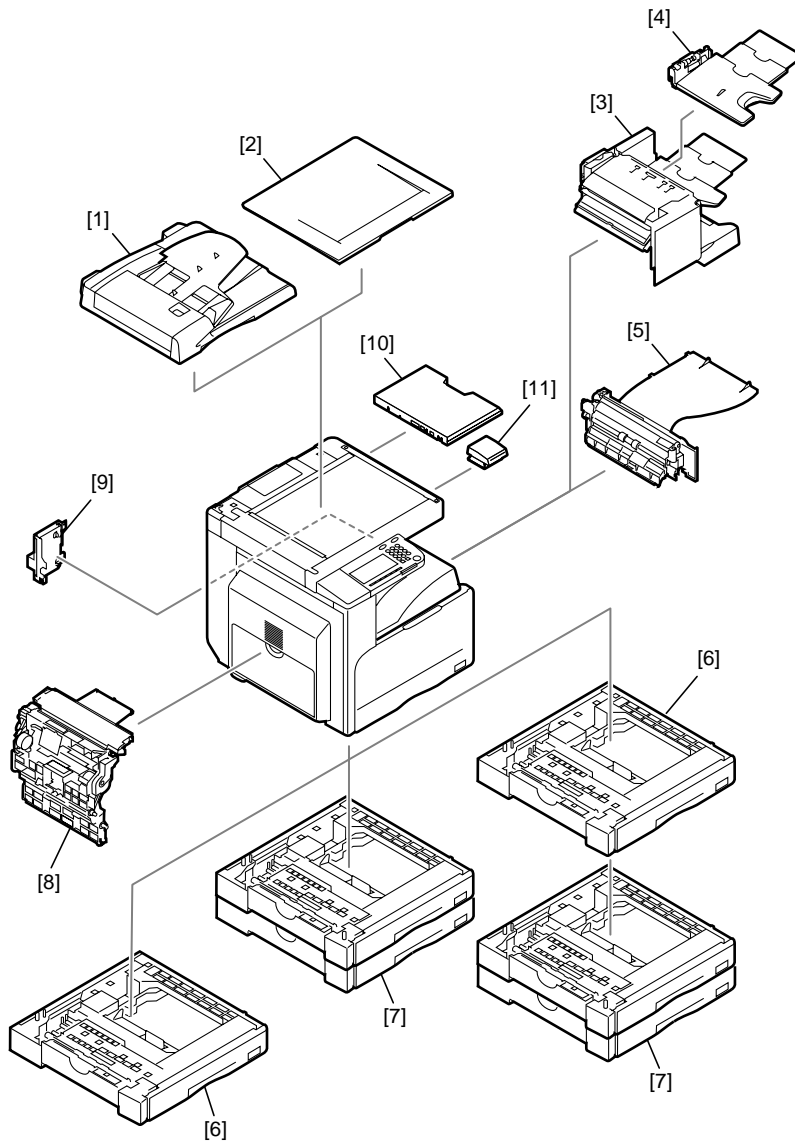

F-1-2

[1]	DADF-P1	
[2]	Platen Cover Type J	*1
[3]	Finisher-U1	
[4]	Additional Finisher Tray-C1	
[5]	Inner 2-way Tray-E1	
[6]	Cassette Feeding Module-J1	*2
[7]	Cassette Feeding Module-K1	*2
[8]	Duplex Unit-A1	
[9]	Power Supply Kit-Q1	*3
[10]	Document Tray-J1	
[11]	Card Reader-E1	

*1: This accessory comes standard with the models for Asia excluding Taiwan and the models for some Latin American countries.

*2: A Cassette feeding module-J1 can be placed on the Cassette feeding module-K1 to use these cassette units as a 3-stage cassette unit.

*3: This accessory is required when the Finisher-U1, Inner 2-way tray-E1, Cassette feeding module-K1 or Duplex unit-A1 is installed. This accessory comes standard with the iR2016 for North America, Latin America and Asia.

1.1.3 Reader Heater/ Cassette Heater System Configuration

iR2016J / iR2016 / iR2020 /

The configuration is as shown in the following figure:

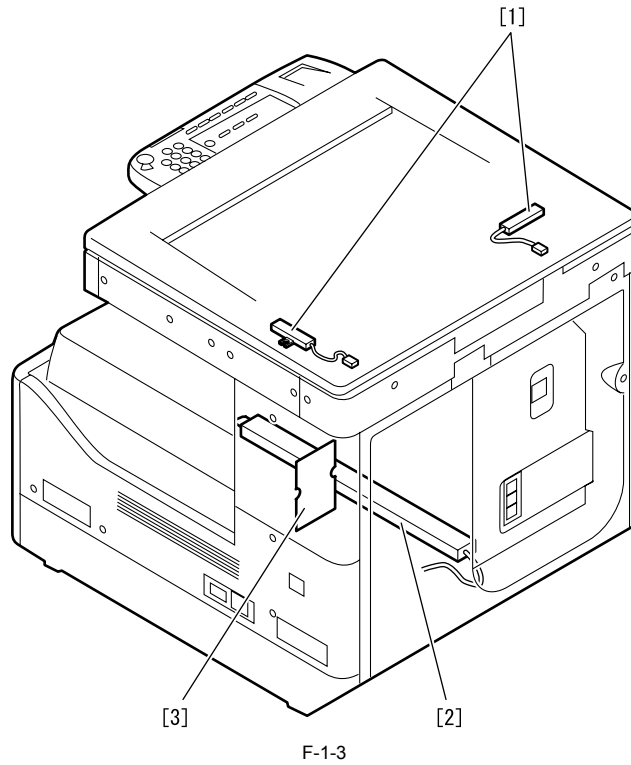

[1]	Reader Heater	*1
[2]	Cassette Heater	*1
[3]	Heater PCB	

*1: To operate the heaters, a heater PCB is required.

1.1.4 Printing/Transmitting Accessories System Configuration (iR2020J/iR2016J)

iR2016J /

The iR202J/iR2016J does not allow the print function and the transmission function to be added.

1.1.5 Printing/Transmitting Accessories System Configuration (iR2020/iR2016)
iR2016 / iR2020

The configuration is as shown in the following figure:

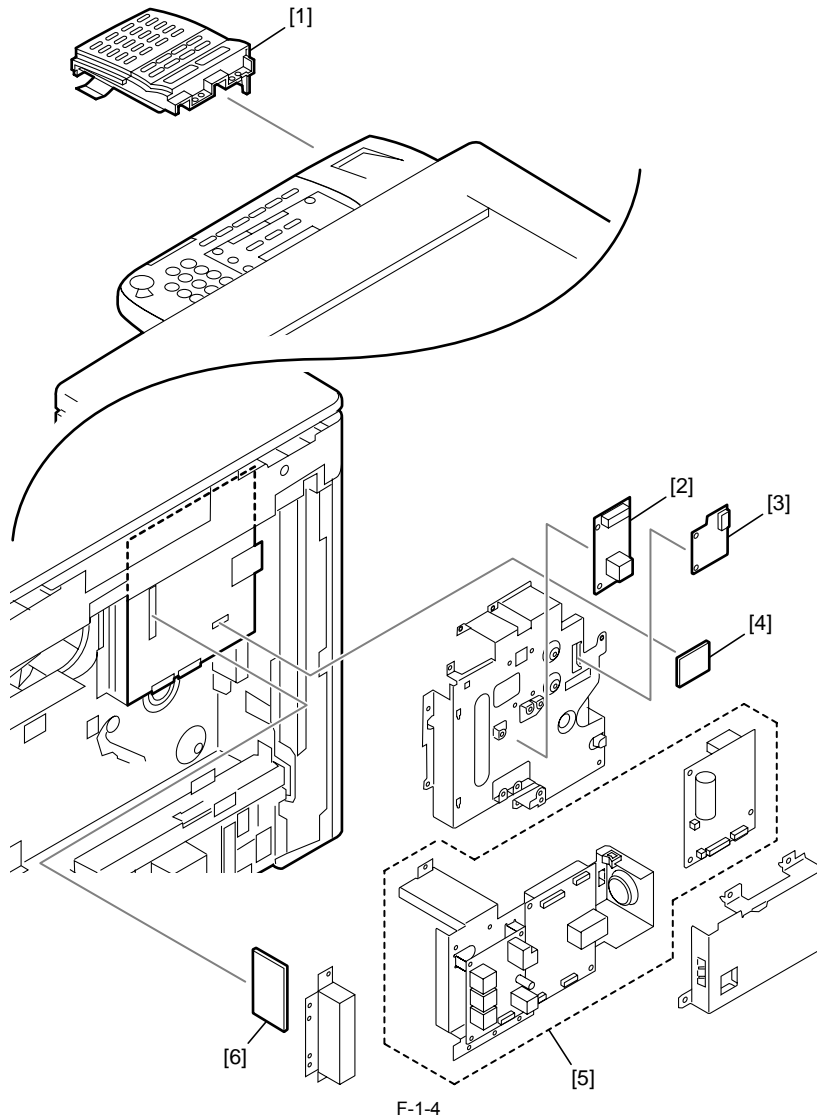

- | | | |
|-----|---------------------------|----|
| [1] | FAX Panel-A1 | *1 |
| [2] | UFR II LT Printer Kit-J2 | |
| [3] | Serial Interface Board-A1 | |
| [4] | PCL Printer Kit-J1 | *2 |
| [5] | Super G3 FAX Board-T1 | *1 |
| [6] | iR 256MB Expansion RAM-D1 | |

*1: To make the FAX feature effective, a FAX panel and a super G3 FAX board are required.

*2: The PCL printer kit contains a 256MB expansion RAM.

1.1.6 Functions of the Printing/Transmission Functions (iR2020/iR2016)

iR2016 / iR2020

The following is a brief explanation of the functions expected of the accessories; for details, see the chapters that follow:

- | | | |
|---|-----|---------------------------|
| UFR II print function (Resolution: 600dpi) | ==> | UFR II LT Printer Kit-J2 |
| UFR II print function (Resolution: 1200dpi) | ==> | UFR II LT Printer Kit-J2 |
| | | iR 256MB Expansion RAM-D1 |
| PCL print function | ==> | PCL Printer Kit-J1 |
| FAX function | ==> | Super G3 FAX Board-T1 |
| | | FAX Panel-A1 |
| Coin vender function | ==> | Serial Interface Board-A1 |

Sample manual. Download All pages at:

<https://www.arepairmanual.com/downloads/2005-2006-canon-ir20202016-series-printer-service-repair-workshop-manual/>